

Thank you for purchasing a Honda lawn mower.

This manual covers the operation and maintenance of the Honda HRJ196 lawn mower.

We want to help you get the best results from your mower and to operate it safely. This manual contains the information on how to do that; please read it carefully.

This manual should be considered a permanent part of the lawn mower and should remain with it, if it is resold.

If you have a problem or questions concerning the mower, contact your supplying dealer.

We recommend that you read the guarantee policy to fully understand your rights and responsibilities. The guarantee policy is a separate document provided by your dealer.

Honda Motor Co., Ltd. reserves the right to make changes at any time without notice and without incurring any obligation.

No part of this publication may be reproduced without written permission.

SAFETY MESSAGES

Pay special attention to statements preceded by the following words;

▲ DANGER

You WILL be KILLED or SERIOUSLY HURT if you don't follow instructions.

▲ WARNING

You CAN be KILLED or SERIOUSLY HURT if you don't follow instructions.

▲ CAUTION

You CAN be HURT if you don't follow instructions.

Each message tells you what the hazard is, what can happen, and what you can do to avoid or reduce injury.

DAMAGE PREVENTION MESSAGES

You will also see other important messages that are preceded by the following word:

NOTICE

Your lawn mower or other property can be damaged if you don't follow instructions.

The purpose of these messages is to help prevent damage to your lawn mower, other property, or the environment.

Do not use this lawn mower except for mowing.

Honda Motor Co., Ltd. 2012, All Rights Reserved

CONTENTS

1. SAFETY INSTRUCTIONS	4
SAFETY LABEL LOCATIONS	7
2. COMPONENT IDENTIFICATION	8
3. CONTROLS	10
DESCRIPTION OF CONTROLS	10
Fuel Valve	10
Throttle Lever	10
Flywheel Brake Lever	11
Cutting Height Adjustment Lever	12
Front Guard	13
4. PRE-OPERATION CHECKS	14
ARE YOU READY TO MOW?	14
CHECK YOUR LAWN	14
CHECK YOUR MOWER	15
Blade	15
Engine Oil Level	18
Fuel	19
Air Cleaner	20
Grass Bag	20
Cutting Height	22
5. OPERATION	23
MOWING PRECAUTIONS	23
STARTING THE ENGINE	23
OPERATING THE CONTROLS FOR MOWING	26
Throttle Lever	26
Flywheel Brake Lever	26
STOPPING THE ENGINE	27
Emergency Engine Stop	27
Normal Engine Stop	27
SAFE MOWING PRACTICES	29
MOWING TIPS	31

6. TRANSPORTING/STORAGE	34
BEFORE LOADING	34
LOADING AND UNLOADING	34
STORAGE PREPARATION.....	35
Cleaning	35
Fuel	36
Draining the Fuel Tank and Carburetor	37
Engine Oil	37
Engine Cylinder.....	37
Handlebar Folding	38
Handlebar Setting	38
STORAGE PRECAUTIONS	39
REMOVAL FROM STORAGE	39
7. MAINTENANCE.....	40
THE IMPORTANCE OF MAINTENANCE	40
MAINTENANCE SAFETY	41
MAINTENANCE SCHEDULE	42
ENGINE MAINTENANCE.....	43
Engine Oil Change.....	43
Engine Oil Recommendations.....	44
Air Cleaner Service	45
Flywheel Brake Lever Operation Inspection.....	46
Spark Plug Service	46
Carburetor Modification for Altitude Operation.....	48
Fuel Recommendations.....	48
BLADE REMOVAL AND INSTALLATION	49
GRASS BAG CLEANING AND REPLACEMENT	54
8. TROUBLESHOOTING	55
9. SPECIFICATIONS	57
10. SET-UP INSTRUCTION	59
11. INDEX.....	61

1. SAFETY INSTRUCTIONS

▲WARNING

– To ensure safe operation

- Read and understand the Owner's Manual before operating the mower. Failure to do so could result in personal injury or equipment damage.
- Read instructions carefully, become familiar with controls and proper use of equipment. Know how to stop the engine rapidly.
- Never allow children or people unfamiliar with these instructions to use the lawn mower.
- Never mow while people, especially children, or pets are nearby.
- Keep in mind that the operator or user is responsible for accidents or hazards occurring to other people or their property.
- Use the mower for the purpose it is intended for, that is regular mowing.
- Always abide by the rules, laws and other safety regulations.
- While mowing, always wear substantial footwear and long trousers. Do not operate the equipment when barefoot or wearing open sandals.
- Thoroughly inspect the area where the equipment is to be used and remove all objects which may be thrown by the machine.
- Gasoline is highly flammable:
 - Store fuel in containers specifically designed for this purpose.
 - Refuel outdoors only and do not smoke while refueling.
 - Add fuel before starting the engine. Never remove the cap of the fuel tank or add gasoline while the engine is running or when the engine is hot.
 - If gasoline is spilled, do not attempt to start the engine but move the machine away from the area of spillage and avoid creating any source of ignition until the gasoline vapors have dissipated.
 - Install the fuel filler cap securely.
- Visually inspect the mower, including attachments, for any damage and looseness of fastening parts, before each use.
- Look around and underneath the engine for signs of oil or gasoline leaks, before each use.
- Check that there is no abnormal sound or vibration from the mower, before each use.

-
- Before using, always visually inspect to see that the blade, blade bolt(s) and cutter housing are not worn or damaged. Replace worn or damaged blade and bolt(s) in sets to preserve balance.
 - Do not operate the engine in a confined space where dangerous carbon monoxide fumes can collect.
 - Mow only in daylight or good artificial light.
 - Avoid operating the equipment in wet grass, where feasible.
 - Mowing on slopes:
 - Always be sure of your footing on slopes.
 - Mow across slopes, never up and down.
 - Walk, never run.
 - Exercise extreme caution when changing direction on slopes.
 - Do not mow excessively steep slopes.
 - Use extreme caution when reversing or pulling the lawn mower toward you.
 - Stop the blade if the lawn mower has to be tilted for transporting, when crossing surfaces other than grass and when transporting the lawn mower to and from the area to be mowed.
 - Never operate the lawn mower with defective guards or shields, or without guards devices (for example, discharge guard).
 - Do not attempt to make cutting height adjustments while the engine is running.
 - Do not change the engine governor setting or over-speed the engine.
 - Start the engine carefully according to the instructions and with feet well away from the blade.
 - Do not tilt the lawn mower when starting the engine.
 - Do not start the engine when standing in front of the discharge guard opening.
 - Do not put hands or feet near or under rotating parts. Keep clear of the discharge guard opening at all times.

-
- **Never pick up or carry a lawn mower while the engine is running.**
 - **Stop the engine and disconnect the spark plug cap:**
 - Before clearing a blockage or unclogging the lawn mower.
 - Before checking, cleaning or working on the lawn mower.
 - After striking a foreign object. Inspect the lawn mower for damage and make repairs before restarting and operating the lawn mower.
 - If lawn mower starts to vibrate abnormally, check immediately.
 - **Stop the engine:**
 - Whenever you leave the lawn mower.
 - Before refueling the lawn mower.
 - **Reduce the throttle setting during engine shut down and turn the fuel valve off at the conclusion of mowing.**
 - **Any part from the machine is a potential source of danger if the machine is used in abnormal conditions or if the maintenance is not done correctly.**
 - **Keep all nuts, bolts and screws tight to be sure the equipment is in safe working condition.**
 - **Never store the equipment with gasoline in the tank inside a building where fumes may reach an open flame or spark.**
 - **Allow the engine to cool before storing in any enclosure.**
 - **To reduce the fire hazard, keep the engine, muffler, battery compartment (if applicable) and gasoline storage area free of grass, leaves or excessive grease.**
 - **Replace worn or damaged parts for safety.**
 - **If the fuel tank has to be drained, this should be done outdoors.**
 - **Wear eye protection.**
 - **To protect you from vibrations, wear appropriate work gloves or limit work hours, and keep engine speed at an appropriate level.**
 - **To protect you from noises, wear ear plugs or limit work hours. Also, check that the exhaust muffler and the blades are properly installed.**
 - **To avoid injury, do not touch or remove the springs from the mower.**
 - **Do not disassemble this machine by yourself, unexpected injury may result.**
 - **The manufacturer will not assume any liability of the machine, damages to the machine or personal injury resulting from unauthorized modification of the machine.**
 - **Consult your servicing dealer for parts replacement, or at the time of disposal of your machine.**

SAFETY LABEL LOCATIONS

These labels warn you of potential hazards that can cause serious injury.

Carefully read the meaning of each label. If a label comes off or becomes hard to read, contact your dealer for a replacement.

Also, after a repair or parts replacement, check that the label is attached to the new parts. If not, contact your dealer to attach a label.

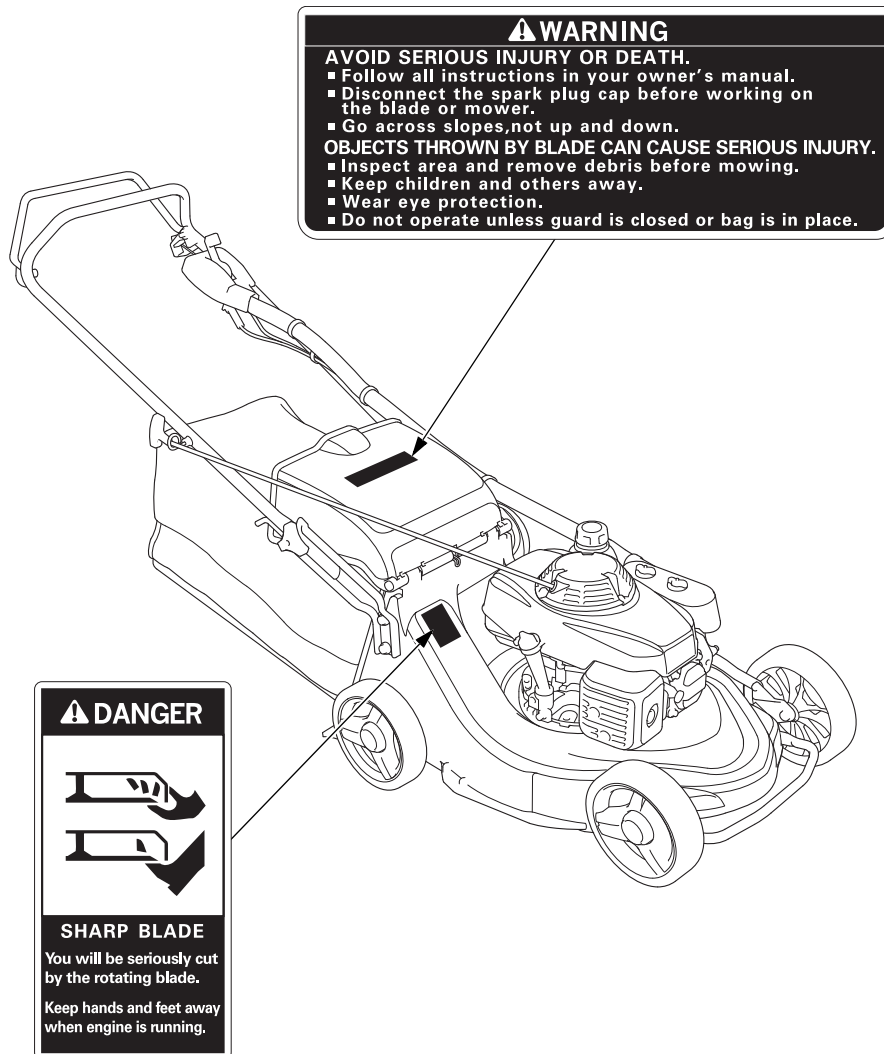

2. COMPONENT IDENTIFICATION

(PDDH and PWDH Types)

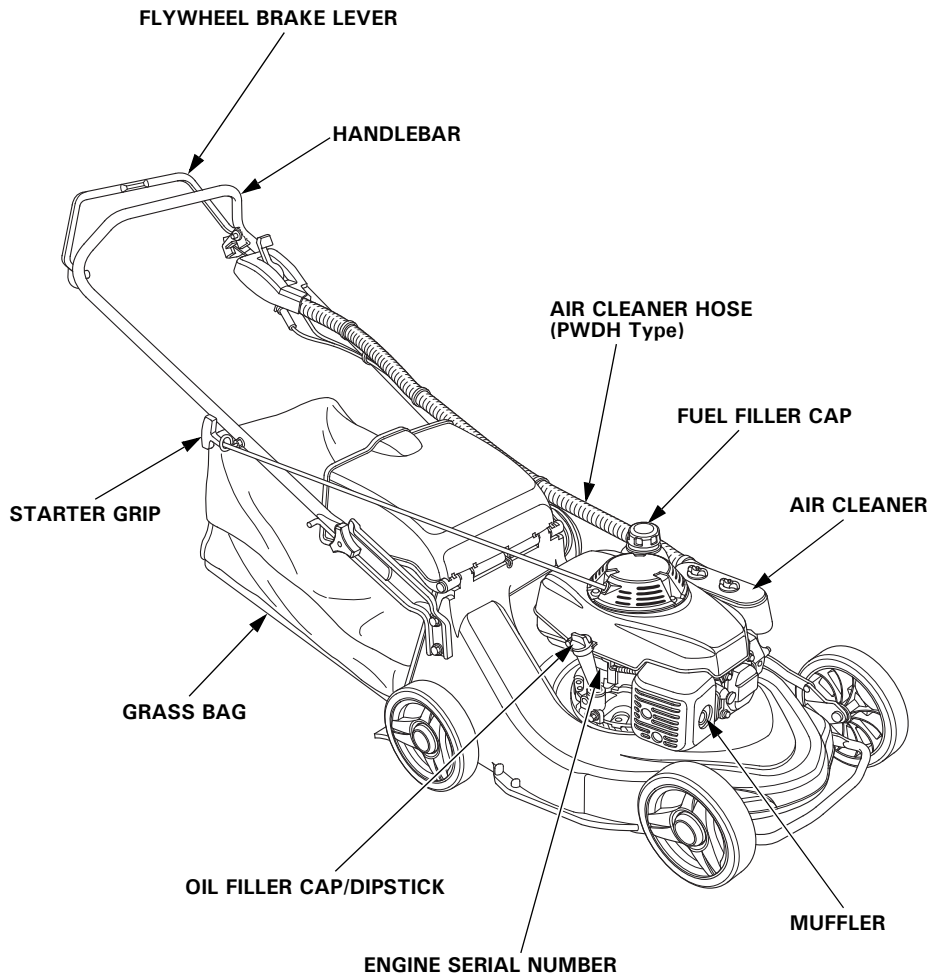

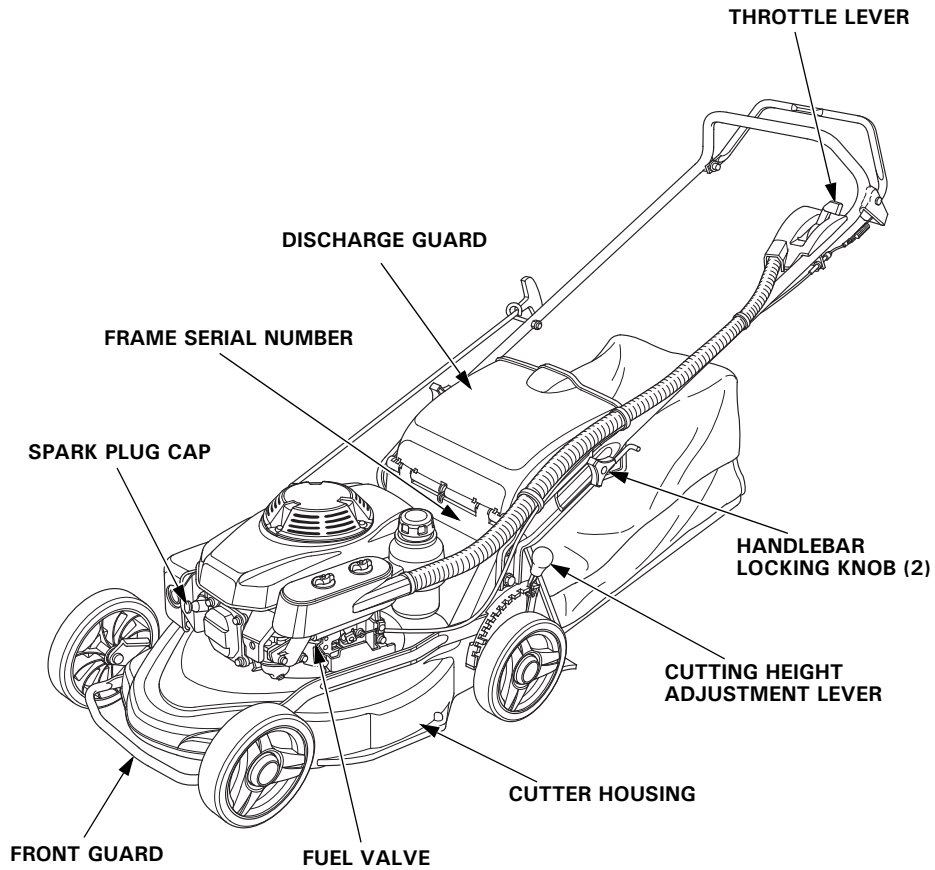

Record the frame and engine serial numbers and date of purchase in the space below. You will need these serial numbers when ordering parts and when making technical or warranty inquiries.

Frame serial number: _____

Engine serial number: _____

Date of purchased: _____

3. CONTROLS

DESCRIPTION OF CONTROLS

Fuel Valve



..... The fuel valve opens and closes the fuel passage from the fuel tank to the carburetor.

The fuel valve must be ON to start and operate the mower. The fuel valve should be kept OFF when the mower is not use.

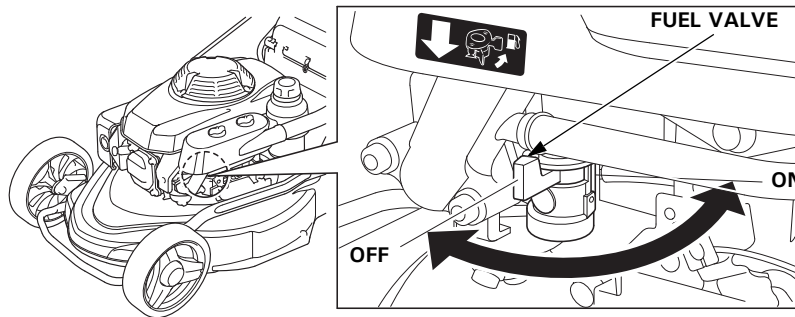

Throttle Lever



CHOKE For starting a cold engine.



HIGH For restarting a warm engine and for mowing.



LOW For idling the engine.

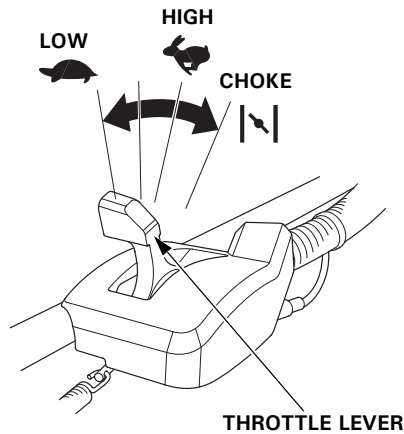

Flywheel Brake Lever

This lever is connected to the engine flywheel brake and the ignition switch. The engine will not start unless this lever is pushed forward.

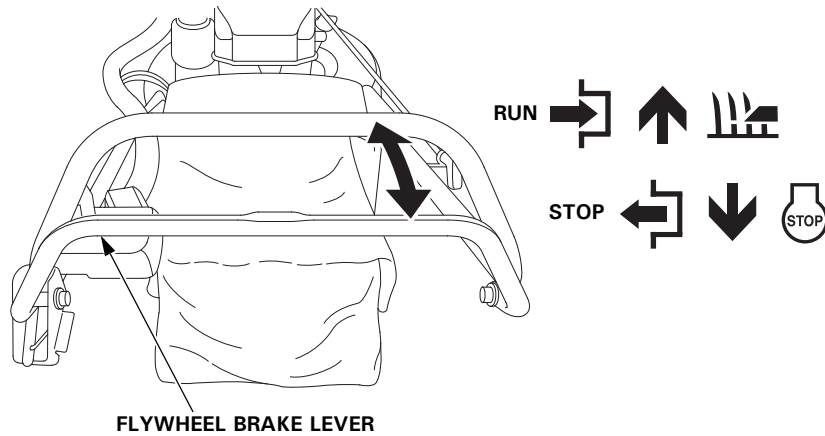

Cutting Height Adjustment Lever

All wheels of the mower can be adjusted to one of lever settings.

The cutting height figures are approximate. The actual height of cut grass will vary with lawn and soil conditions.

Move the adjuster forward to lower and back to raise the cutter housing.

Position	Approx. Height
①	75 mm
②	69 mm
③	63 mm
④	57 mm
⑤	51 mm
⑥	45 mm
⑦	39 mm
⑧	33 mm
⑨	27 mm
⑩	21 mm
⑪	16 mm

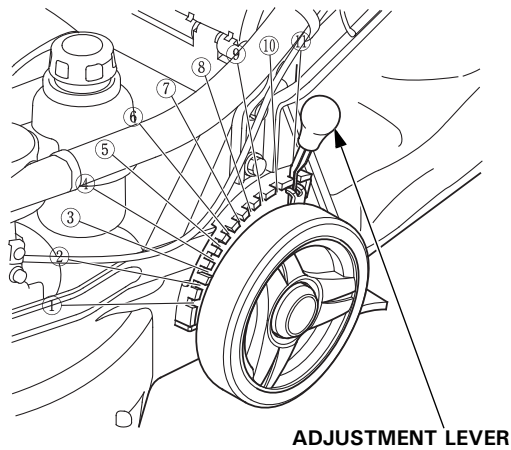

Front Guard

NOTICE

Do not step on the front guard.

Do not use the front guard to lift the lawn mower.

Replace the front guard at your servicing dealer whenever it is deformed.

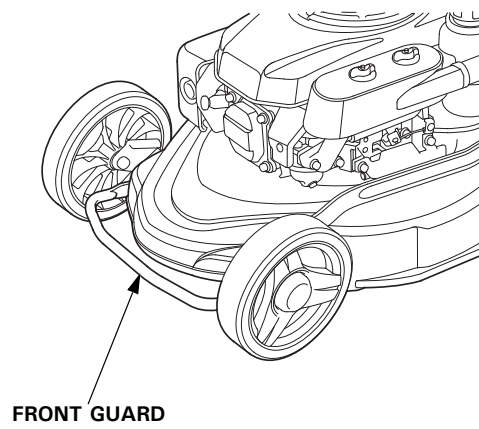

4. PRE-OPERATION CHECKS

ARE YOU READY TO MOW?

Be sure to wear protective clothing. Long pants and eye protection can lower your risk of injury from thrown objects. Wear footwear that protects your feet and won't let you slip if you mow on slopes or uneven ground.

CHECK YOUR LAWN

For your safety and for the safety of others, always inspect the area before mowing.

Objects

Anything which can be picked up by the blade and thrown is a potential hazard to you and others. Look for things like stones, sticks, bones, and wire. Remove them from the mowing area.

People and Pets

People and animals near the mowing area can move into your path or into a position where they could be struck by thrown objects. Clear the area of people and pets, especially children. Their safety is your responsibility.

Lawn

Check the length and condition of the grass, so you will know what cutting height and mowing speed to use.

Avoid mowing wet grass. Not only will wet grass clog your cutter housing and collect in clumps on the lawn, it also gives poor traction, increasing your risk of losing your footing.

CHECK YOUR MOWER

Blade

Before each use, check the cutter blade for damage or excessive wear.

▲WARNING

To avoid severe personal injury, disconnect the spark plug cap to prevent accidental starting, and wear heavy gloves to protect your hands from the cutter blade.

1. Stop the engine and turn the fuel valve to the OFF position (see page 27).
2. Disconnect the spark plug cap from the spark plug (see page 46).
3. Remove the grass bag (if installed) (see page 21).
4. Tilt the mower to the right, so the carburetor side is up. This will help to prevent fuel leakage and hard starting.

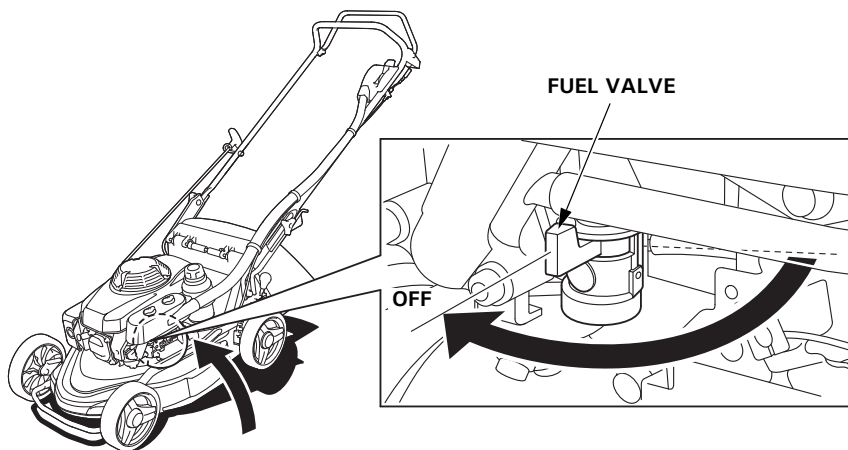

5. Inspect the blades for wear and damage.

6. Check that the blade setting bolts and the blade disc holder bolt are tight (see page 51).

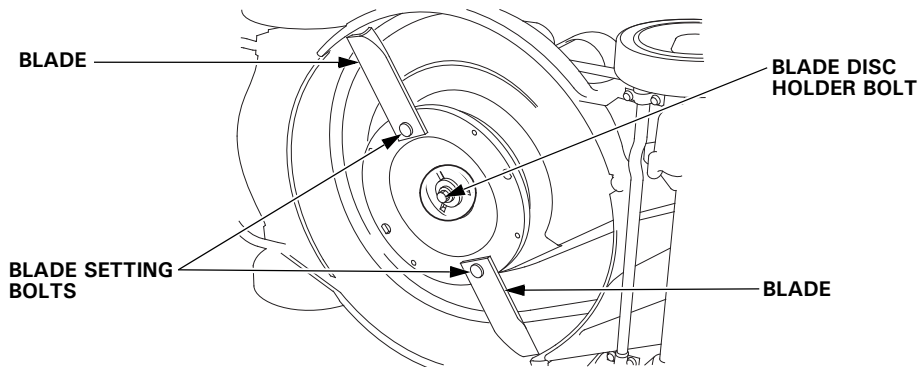

▲WARNING

Never operate the mower with a worn, damaged, split or dented blade. A piece of blade which breaks off and is thrown outwards can cause serious bodily injuries.

NOTICE

Blade wear is increased when the mower is used on sandy soils. Inspect the blade more often when the mower is used in these conditions.

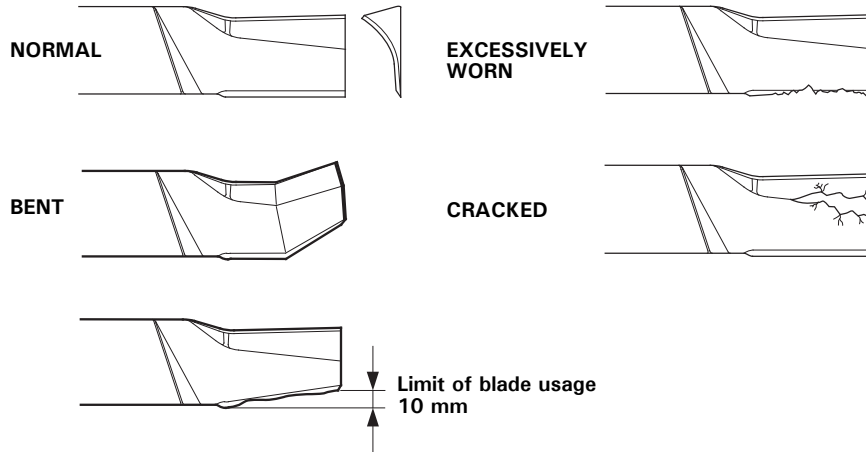

A dull blade can be sharpened, but a blade that is worn out, bent, cracked, or otherwise damaged must be replaced. A worn or damaged blade can break, causing blade pieces to be thrown from the mower.

When a blade needs sharpening or replacement, take the lawn mower to your servicing dealer. Or, if you have a torque wrench and other proper tools, you can remove and install the blade yourself (see page 49).

Engine Oil Level

Check the engine oil level with the engine stopped and the mower on a level surface.

1. Remove the oil filler cap/dipstick and wipe it clean.
2. Insert and remove the dipstick without screwing it into the filler neck. Check the oil level shown on the dipstick.
3. If the oil level is low, fill to the upper limit mark on the dipstick with the recommended oil (see page 44).
4. Reinstall the oil filler cap/dipstick securely.

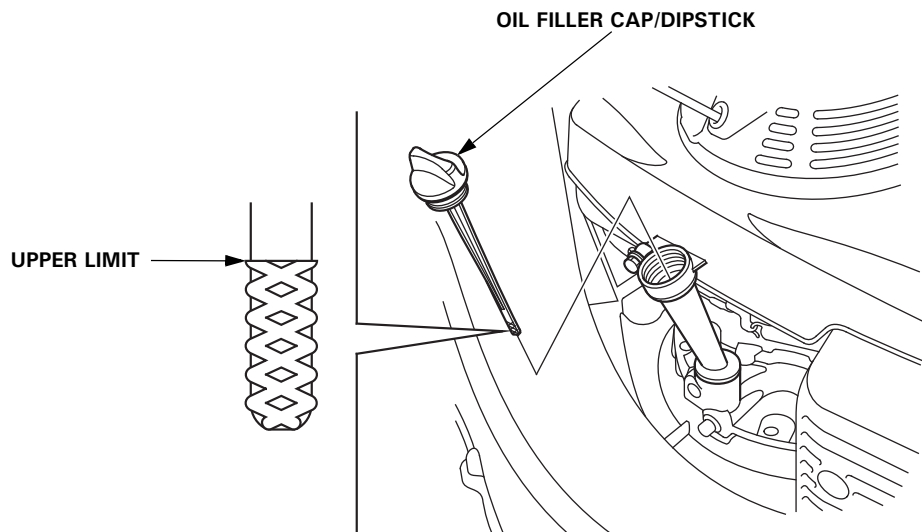

Fuel

Refuel in a well-ventilated area before starting the engine. If the engine has been running, allow it to cool. See page 48 for fuel recommendations.

Remove the fuel filler cap and check the fuel level. Refill the tank if the fuel level is low. Refuel carefully to avoid spilling fuel. Do not overfill; there should be no fuel over the upper limit mark. After refueling, tighten the fuel filler cap securely.

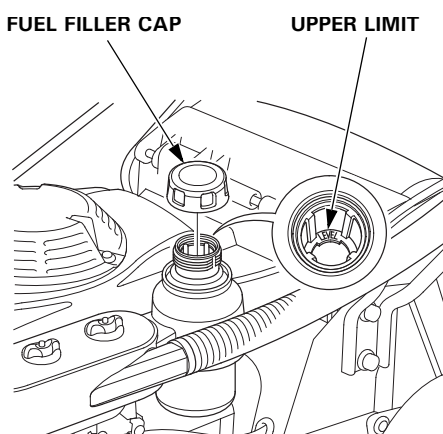

▲WARNING

Gasoline is highly flammable and explosive.

You can be burned or seriously injured when handling fuel.

- Stop the engine and keep heat, sparks, and flame away.
- Handle fuel only outdoors.
- Wipe up spills immediately.

Never refuel the mower inside a building where gasoline fumes may reach flames or sparks. Keep gasoline away from appliance pilot lights, barbecues, electric appliances, power tools, etc.

Spilled fuel is not only a fire hazard, it causes environmental damage. Wipe up spills immediately.

NOTICE

Fuel can damage paint and plastic. Be careful not to spill fuel when filling your fuel tank. Damage caused by spilled fuel is not covered under warranty.

Air Cleaner

Inspection

Make sure the air filters are clean and in good condition. A dirty air filter will restrict air flow to the carburetor, reducing engine performance. Refer to page 45 for air cleaner service.

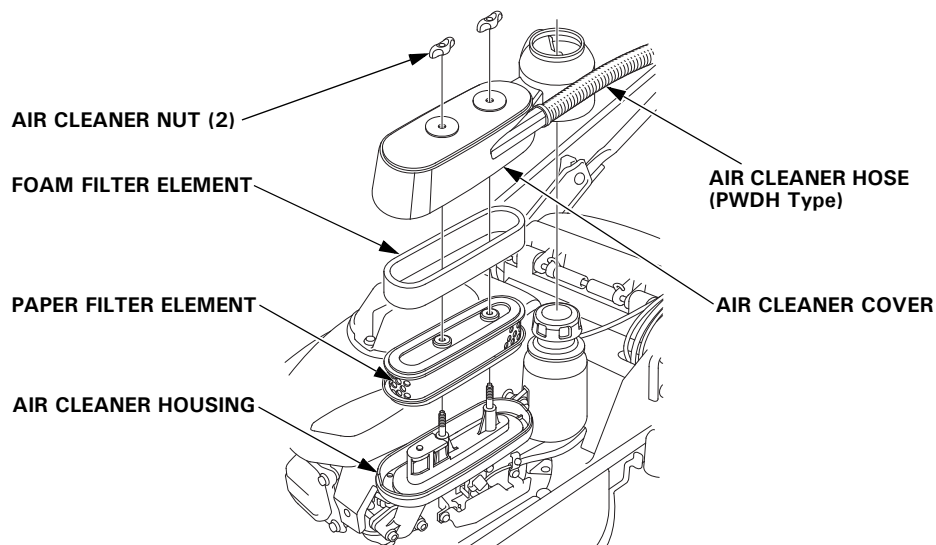

Grass Bag

A lawn mower works like a vacuum cleaner; it blows air through the bag, which traps the grass clippings. Always empty the grass bag before it becomes filled to the limit of its capacity. Bagging performance will diminish after the bag becomes about 90% filled. Also the bag is easier to empty when not packed full.

Inspection

Inspect the grass bag before use. Check for holes, tears, and excessive wear. The grass bag will wear during normal use and will eventually require replacement (see page 54).

Installation

1. Raise the discharge guard, and hook the grass bag frame onto the cutter housing as shown.
2. Release the discharge guard to secure the grass bag in place.

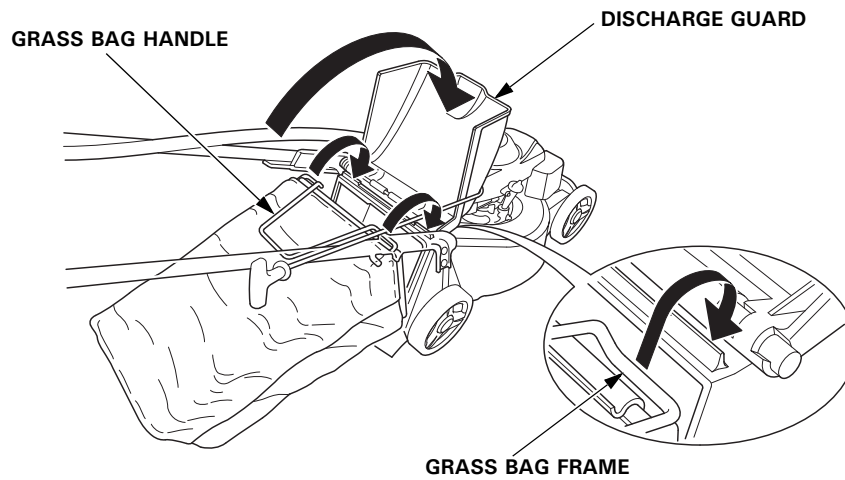

Removal

1. Raise the discharge guard, grasp the grass bag handle and remove the grass bag.
2. Release the discharge guard.
3. When the grass bag is clear of the discharge guard, you can lift the grass bag through the handlebars, or remove it from the rear of the mower below the handlebar.

Cutting Height

Check the cutter housing cutting height settings. The lowest setting is approximately 16 mm and the highest setting is 75 mm. To adjust cutting height, pull the adjustment lever toward the wheel, and move it into another notch.

If you are not sure what cutting height to select, start with a high setting and check the appearance of the lawn after mowing a small area. Then readjust cutting height if necessary.

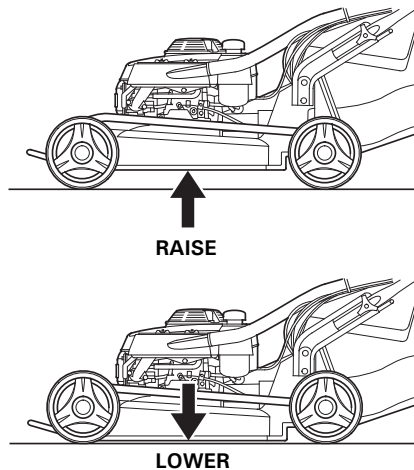
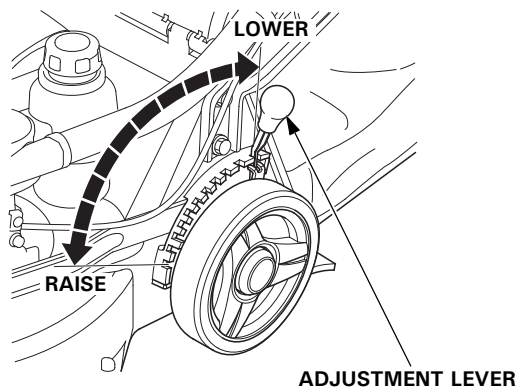

5. OPERATION

MOWING PRECAUTIONS

Before operating the mower for the first time, please review the **SAFETY INSTRUCTIONS** beginning on page 4 and **SAFE MOWING PRACTICES** on pages 29 and 30.

Even if you have operated other mowers, take time to become familiar with how this mower works and practice in a safe area until you build up your skills.

For your safety, avoid starting or operating the engine in an enclosed area such as a garage. Your mower's exhaust contains poisonous carbon monoxide gas which can collect rapidly in an enclosed area and cause illness or death.

STARTING THE ENGINE

The blade turns when you operate the starter. It is easier to start the engine in a clear or mowed area where the blade can turn freely.

1. Turn the fuel valve to the ON position.

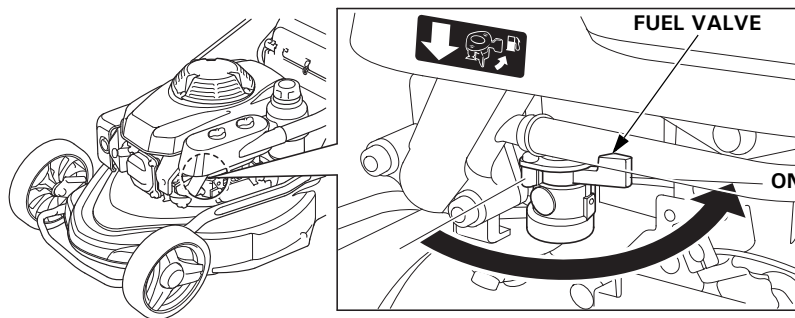

2. Move the throttle lever to the proper starting position.

COLD ENGINE:

Move the throttle lever to the **CHOKE** position.

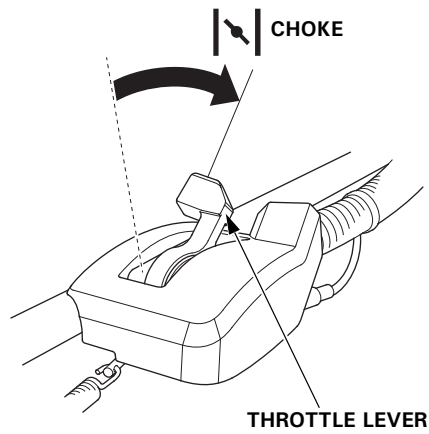

WARM ENGINE:

Move the throttle lever to the **HIGH** position.

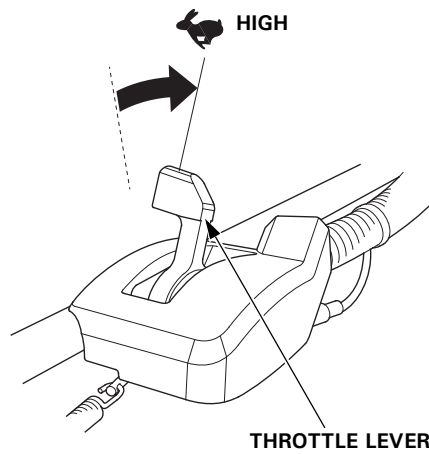

3. By standing in the back side of the mower at the operating position, push the flywheel brake lever forward and hold it against the handlebar.

Pull the starter grip lightly until you feel resistance, then pull briskly in the direction of the arrow as shown below. Return the starter grip gently.

Keep your hands and feet away from the cutter housing at all times when starting and running the engine.

Continue to hold the flywheel brake lever against the handlebar; the engine will stop if you release the lever.

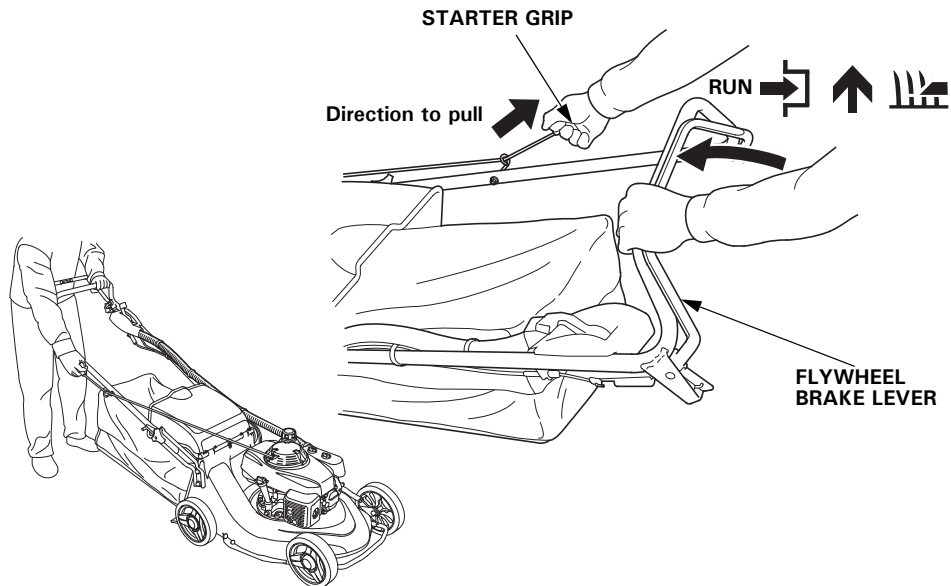

4. If the CHOKE position was used during starting, move the throttle lever away from the CHOKE position as soon as the engine warms up enough to run smoothly. Set the throttle lever at HIGH to mow or at LOW to idle.

OPERATING THE CONTROLS FOR MOWING

Throttle Lever

For best cut quality, always mow with the throttle lever in the HIGH position. When the blade rotates at the preset fast speed, it creates a strong fan action that lifts and cuts grass more efficiently. Do not try to increase the preset engine speed, the blade could fracture and come apart.

When you need to leave the mower for any reason, always turn the engine OFF by releasing the flywheel brake lever.

Flywheel Brake Lever

The lever must be pushed forward against the handlebar to start the engine. If the lever is released backward from the handlebar, the starter grip can not be pulled because the flywheel brake hold the flywheel. Continue to hold the lever against the handlebar to keep the engine running and the blade rotating.

Release the lever to stop the engine and stop blade rotation.

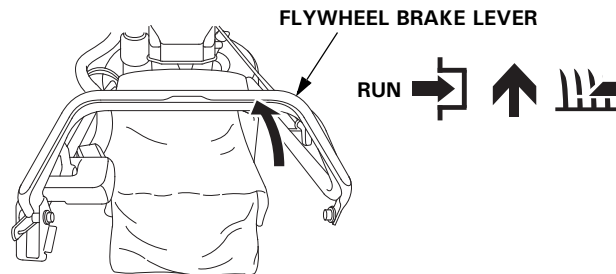

STOPPING THE ENGINE

Emergency Engine Stop

Release the flywheel brake lever.

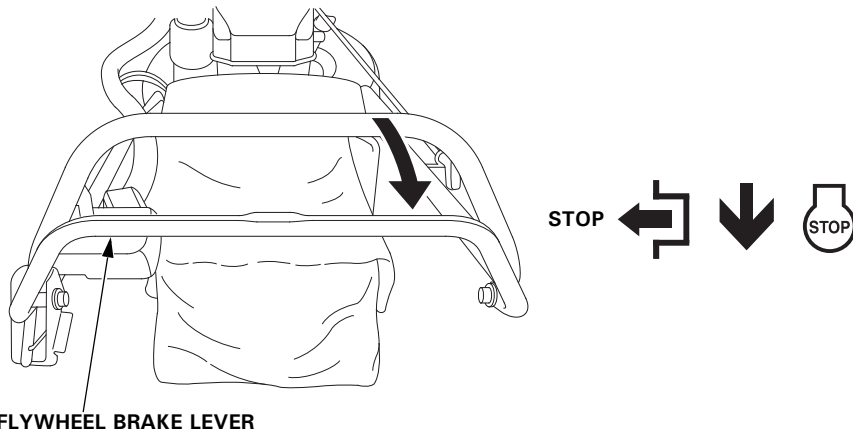

Normal Engine Stop

1. Move the throttle lever to the LOW position.

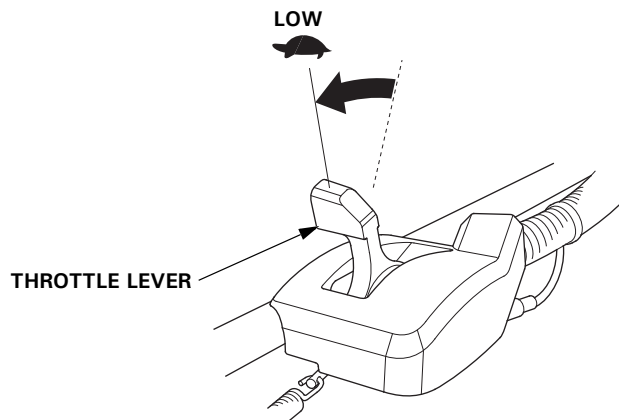

2. Release the flywheel brake lever.

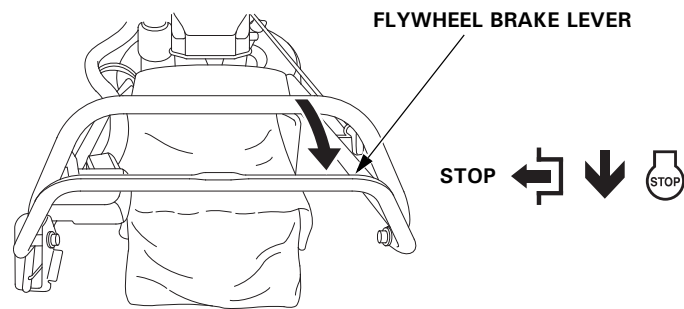

3. When the mower is not in use, turn the fuel valve to the OFF position.

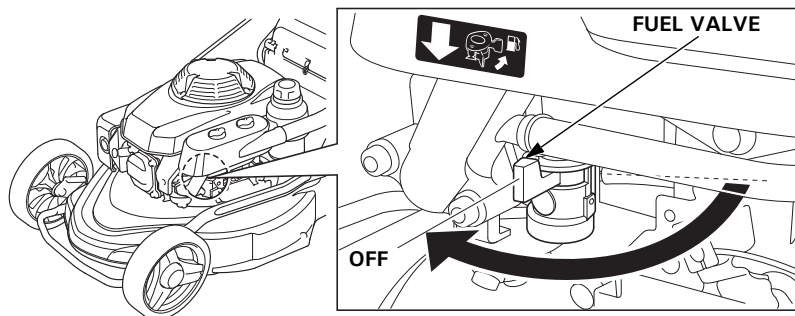

SAFE MOWING PRACTICES

For your safety, keep all four wheels on the ground and be careful to avoid losing your footing and your control of the mower. Keep a firm grip on the handlebar, and walk, never run, with the mower. Be very careful when mowing uneven or rough ground.

If stuck, do not kick or shove the mower with your foot. Use the handlebar to control the mower.

▲WARNING

The blade is sharp and spins at high speed.

A spinning blade can cut you severely and can amputate fingers and toes.

- **Wear protective footwear.**
- **Keep your hands and feet away from the cutter housing while the engine is running.**
- **Stop the engine before performing any adjustment, inspection, or maintenance.**

Slopes

Mow across slopes, not up and down. Avoid steep slopes (more than 20°), and be careful when changing direction. Mowing on a slope when the grass is damp or wet could cause you to slip, fall, and lose control of the mower.

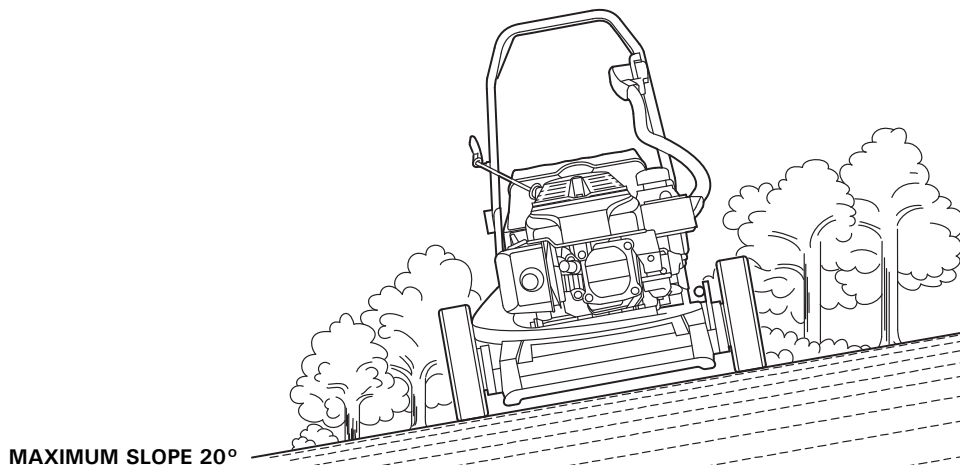

Obstacles

Use the side of the mower to cut close to large obstacles, such as fences or walls.

Push the mower around obstacles for better directional control. Be careful when mowing over obstacles embedded in the lawn, such as sprinkler heads, paving, edging, etc. Avoid anything that sticks up above the surface of the lawn.

If the blade hits something, or if the mower starts to vibrate, stop the engine immediately, disconnect the spark plug cap, and check for damage (see page 15). Striking objects may damage the blade, bend the crankshaft, and/or break the cutter housing or other components. Vibration usually indicates serious trouble.

▲WARNING

A worn, cracked, or damaged blade can break, and pieces of the damaged blade can become dangerous projectiles.

Thrown objects can cause serious injury.

Inspect the blade regularly, and do not operate the mower with a worn or damaged blade.

The Warranty does not cover parts damaged by accident or collision.

Gravel and Loose Objects

Gravel, loose stones, and landscaping material can be picked up by the mower and thrown many feet with enough force to cause serious personal injury and/or property damage. The best way to prevent potential injury from thrown objects is to release the flywheel brake lever to stop the blade before reaching areas with gravel, loose stones, or landscaping material.

MOWING TIPS

Cutting Height

Consult a local nursery or lawn and garden center for cutting height recommendations and advice about specific types of grasses and growing conditions in your area.



If you look closely, you'll see that most grass has stems and leaves. If you cut off the leaves, you'll scalp the lawn. Let the grass recover between mowings. Your mower will work better, and your lawn will look better.

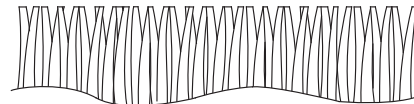

LONG ENOUGH

If your grass gets too tall, cut it once at the highest cutting height setting, then mow again in 2 or 3 days. Don't take off more than one third of total grass height in any one mowing, or brown patches may develop.



TOO SHORT

Cutting height adjustment is explained on page 22.

Cutting Width

For an even lawn finish, overlap each mowing swath by approximate 10 cm. If the grass is very tall or thick, use more overlap and a narrower mowing swath.

Blade Speed

The blade must spin very fast to cut properly. Always use the HIGH throttle setting, and keep the engine running at maximum rpm. If engine speed drops, it could mean the engine is being overloaded by the blade trying to cut too much grass. Mow a narrower swath, move the mower slower, or raise the cutting height.

Blade Sharpness

A sharp blade cuts cleanly. A dull blade tears the grass, leaving shredded ends that turn brown. When your blade doesn't cut cleanly anymore, have it sharpened or replaced.

Dry Grass

If the ground is too dry, mowing will stir up a lot of dust. Besides being unpleasant to work in, too much dust will clog the carburetor air filter. If dust is a problem, water your lawn the day before mowing. Mow when the grass is dry to your touch, but the soil is still moist.

Wet Grass

Wet grass is slippery and can make you lose your footing. Also, wet grass clippings will clog the cutter housing and collect in clumps on the lawn. Always wait for wet grass to dry before mowing.

Fallen Leaves

When equipped with the grass bag, your mower can be used to pick up fallen leaves for disposal. If using the mower to bag large amount of fallen leaves, and not for mowing, set the cutting height adjustment lever at highest setting.

If you want to mulch fallen leaves into your lawn, don't let the leaf cover get too deep before you begin. For best results, start mulching while grass still shows through the leaf cover. In places where fallen leaves completely cover the grass remove the leaves by raking, or install a grass bag, so your mower can pick them up for disposal.

Clogged Cutter Housing

Before clearing a clogged cutter housing, stop the engine and turn the fuel valve to the OFF position. With the spark plug cap disconnected, tilt the mower so the carburetor side is up.

Clear a clogged deck with a stick, not by your hands.

Mowing Patterns

Your Honda mower will work most efficiently if you use the following mowing patterns as much as possible. Cutter housing and equipment design, and the direction in which the blade rotates, cause these mowing patterns to give the best results.

Bagging

Use a clockwise mowing pattern. This will give the best bagging performance, leaving the least amount of clippings on the lawn.

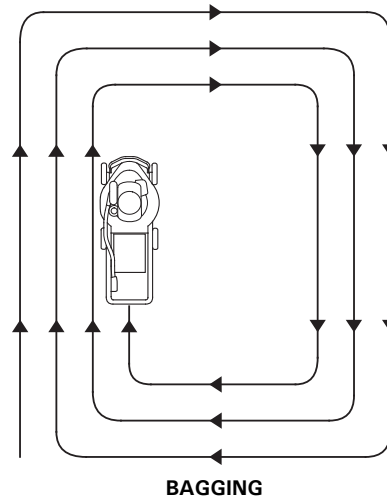

6. TRANSPORTING/STORAGE

BEFORE LOADING

Stop the engine and turn the fuel valve to the OFF position. This will prevent carburetor flooding and reduce the possibility of fuel leakage. If the engine has been running, allow it to cool for at least 15 minutes before loading the mower on the transport vehicle. A hot engine and exhaust system can burn you and can ignite some materials. Disconnect the spark plug cap from the spark plug (see page 46).

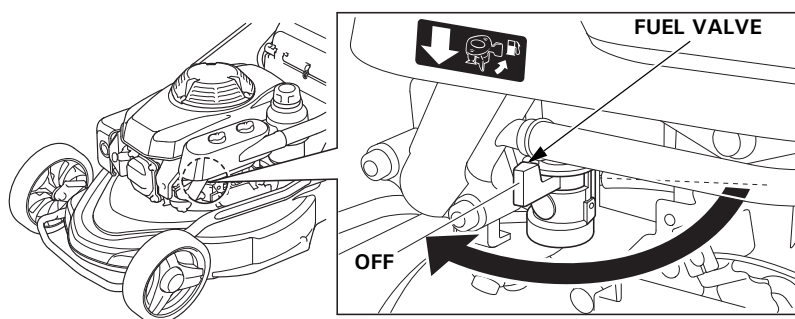

If equipped, remove the grass bag.

LOADING AND UNLOADING

If a suitable loading ramp is not available, two people should lift the mower on and off the transport vehicle while holding the mower level. Position the mower so all four wheels are on the bed of the transport vehicle. Tie the mower down with rope or straps, and block the wheels. Keep the tie-down rope or straps away from the controls, adjustment levers, cables, and the carburetor. The handlebar can be folded so the mower will take up less space (see page 38).

STORAGE PREPARATION

Proper storage preparation is essential for keeping your lawn mower trouble-free and looking good. The following steps will help to keep rust and corrosion from impairing your lawn mower's function and appearance, and will make the engine easier to start when you use the lawn mower again.

Cleaning

1. Wash the lawn mower, including the underside of the cutter housing.

Engine

Wash the engine by hand, and be careful to prevent water from entering the air cleaner and/or muffler.

NOTICE

- Using a garden hose or pressure washing equipment can force water into the air cleaner. Water in the air cleaner will soak the filters and can enter the carburetor or engine, causing damage.
- Water on a hot engine can cause damage. If the engine has been running, allow it to cool for at least 30 minutes before washing.

Cutter Housing

If using a garden hose or pressure washing equipment to clean the cutter housing, be careful to avoid getting water into controls and cables, or anywhere near the engine air cleaner or muffler opening. Before washing the underside of the cutter housing, be sure the fuel valve is in the OFF position. Disconnect the spark plug cap. Reset the mower on its right side, so the carburetor side is up. This will help to prevent fuel leakage and hard starting due to carburetor flooding. Wear heavy gloves to protect your hands from the blade.

2. After washing the lawn mower, wipe dry all accessible surfaces.
3. With the mower in an upright position, start the engine outdoors, and let it run until it reaches normal operating temperature to evaporate any water remaining on the engine.
4. Stop the engine and allow it to cool.
5. After the lawn mower is clean and dry, touch up any damaged paint, and coat other areas that may rust with a light film of oil. Lubricate the control cable cores with a silicone spray lubricant.

Fuel

Gasoline will oxidize and deteriorate in storage. Old gasoline will cause hard starting, and it leaves gum deposits that clog the fuel system. If the gasoline in your mower deteriorates during storage, you may need to have the carburetor and other fuel system components serviced or replaced.

The length of time that gasoline can be left in your fuel tank and carburetor without causing functional problems will vary with such factors as gasoline blend, your storage temperatures, and whether the fuel tank is partially or completely filled. The air in a partially filled fuel tank promotes fuel deterioration. Very warm storage temperatures accelerate fuel deterioration. Fuel deterioration problems may occur within 30 days, or even less if the gasoline was not fresh when you filled the fuel tank.

The Warranty does not cover fuel system damage or engine performance problems resulting from neglected storage preparation.

You can avoid fuel deterioration problems by draining the fuel tank and carburetor.

NOTICE

Gasoline spoils very quickly depending on factors such as light exposure, temperature and time.

In worst cases, gasoline can be contaminated within 30 days. Using contaminated gasoline can seriously damage the engine (carburetor clogged, valve stuck).

Such damage due to spoiled fuel is disallowed from coverage by the warranty.

To avoid this please strictly follow these recommendations:

- Only use specified gasoline (see page 48).
- Use fresh and clean gasoline.
- To slow deterioration, keep gasoline in a certified fuel container.
- If long storage (more than 30 days) is foreseen, drain fuel tank and carburetor (see page 37).

Draining the Fuel Tank and Carburetor

1. Empty the fuel tank into an approved gasoline container.
2. Remove the carburetor drain bolt with a 10 mm wrench, and drain the carburetor bowl fuel into an approved container.

▲WARNING

Gasoline is highly flammable and explosive.

You can be burned or seriously injured when handling fuel.

- Stop the engine and keep heat, sparks, and flame away.
- Handle fuel only outdoors.
- Wipe up spills immediately.

3. Turn the fuel valve to the ON position (see page 23). This will allow fuel in the fuel tank to drain through the carburetor bowl. After the fuel is completely drained, reinstall a new sealing washer and the drain bolt.

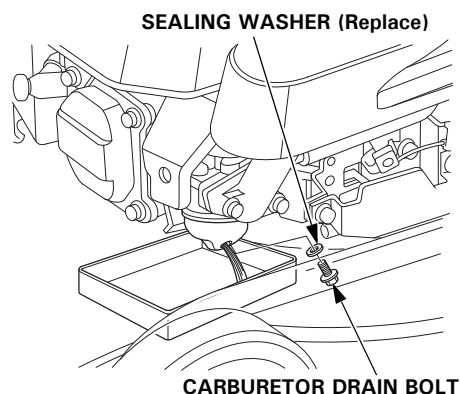

Engine Oil

Change the engine oil (see page 43).

Engine Cylinder

1. Remove the spark plug (see pages 46 and 47).
2. Pour 5–10 cc of clean engine oil into the cylinder.
3. Pull the starter grip several times to distribute the oil in the cylinder. Reinstall the spark plug.
4. Pull the starter grip slowly until resistance is felt, then return the starter grip gently. This closes the valves so moisture cannot enter.

Handlebar Folding

1. Remove the grass bag (if installed) (see page 21).
2. Loosen or remove the two handlebar locking knobs.
3. Pull the handlebar struts to release them from the locating grooves, then swing the handlebar forward with the flywheel brake lever held by your hand. Don't allow the cables and air cleaner hose (PWDH type) to be bent or pinched.
4. Loosely install the two handlebar locking knobs.

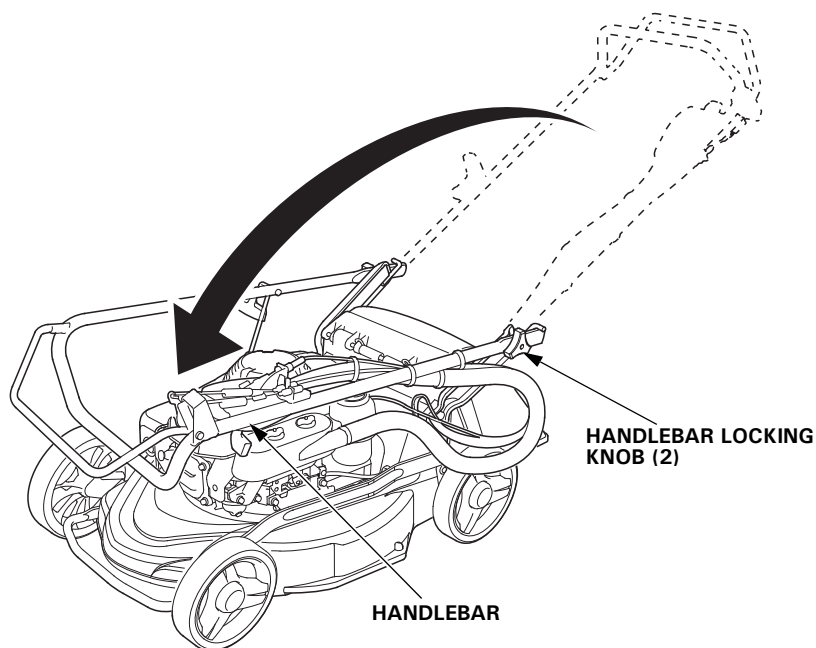

Handlebar Setting

Squeeze the flywheel brake lever to release the flywheel brake and raise the handlebar in place in the reverse order of handlebar folding, taking care that the cable and air cleaner hose (PWDH type) are not bent or pinched.

STORAGE PRECAUTIONS

If your mower will be stored with gasoline in the fuel tank and carburetor, it is important to reduce the hazard of gasoline vapor ignition. Select a well-ventilated storage area away from any appliance that operates with a flame, such as a furnace, water heater, or clothes dryer. Also avoid any area with a spark-producing electric motor, or where power tools are operated.

If possible, avoid storage areas with high humidity, because that promotes rust and corrosion.

Unless all fuel has been drained from the fuel tank, turn the fuel valve to the OFF position to reduce the possibility of fuel leakage.

Place the mower with its wheels on a level surface. Tilting can cause fuel or oil leakage.

The handlebar can be folded for compact storage (see page 38).

With the engine and exhaust system cool, cover the mower to keep out dust. A hot engine and exhaust system can ignite or melt some materials. Do not use plastic sheet as a dust cover. A nonporous cover will trap moisture around the mower, promoting rust and corrosion.

REMOVAL FROM STORAGE

Check your mower as described in the *PRE-OPERATION CHECKS* chapter of this manual (see page 14).

If the fuel was drained during storage preparation, fill the tank with fresh gasoline. If you keep a container of gasoline for refueling, be sure that it contains only fresh gasoline. Gasoline oxidizes and deteriorates over time, causing hard starting.

If the cylinder was coated with oil during storage preparation, the engine may smoke briefly at startup. This is normal.

7. MAINTENANCE

THE IMPORTANCE OF MAINTENANCE

Good maintenance is essential for safe, economical, and trouble-free operation. It will also help reduce air pollution.

▲WARNING

To avoid the mower starting accidentally, pull off the spark plug cap before carrying out maintenance work.

Improper maintenance, or failure to correct a problem before operation, can cause a malfunction in which you can be seriously hurt or killed.

Always follow the inspection and maintenance recommendations and schedules in this owner's manual.

To help you properly care for your mower, the following pages include a maintenance schedule, routine inspection procedures, and simple maintenance procedures using basic hand tools.

Other service tasks that are more difficult, or require special tools, are best handled by professionals and are normally performed by a Honda technician or other qualified mechanic. The maintenance schedule applies to normal operating conditions. If you operate your mower under severe conditions, such as sustained high-load conditions, consult your servicing dealer for recommendations applicable to your individual needs and use.

MAINTENANCE SAFETY

Some of the most important safety precautions follow. However, we cannot warn you of every conceivable hazard that can arise in performing maintenance. Only you can decide whether or not you should perform a given task.

▲WARNING

Failure to properly follow maintenance instructions and precautions can cause you to be seriously hurt or killed.

Always follow the procedures and precautions in this owner's manual.

Safety Precautions

- Make sure the engine is off before you begin any maintenance or repairs. This will eliminate several potential hazards:
 - **Carbon monoxide poisoning from engine exhaust.**
Be sure there is adequate ventilation whenever you operate the engine.
 - **Burns from hot parts.**
Let the engine and exhaust system cool before touching.
 - **Injury from moving parts.**
Do not run the engine unless instructed to do so.
- Read the instructions before you begin, and make sure you have the tools and skills required.
- To reduce the possibility of fire or explosion, be careful when working around gasoline. Use only a nonflammable solvent, not gasoline, to clean parts. Keep cigarette, sparks, and flames away from all fuel-related parts.

Remember that your servicing dealer knows your mower best and is fully equipped to maintain and repair it.

To ensure the best quality and reliability, use only new, Honda genuine parts or their equivalents for repair and replacement.

MAINTENANCE SCHEDULE

REGULAR SERVICE PERIOD (4) Perform at every indicated month or operating hour interval, whichever comes first.		Each use	First month or 20 hrs.	Every 3 months or 50 hrs.	Every 6 months or 100 hrs.	Every year or 200 hrs.	Refer to page
ITEM							
Engine oil	Check level	o					18
	Change		o		o (3)		43
Air cleaner	Check	o (5)					20
	Clean			o (1)			45
	Replace		Every year				45
Flywheel brake pad	Check-adjust				o (2)		-
Spark plug	Check-adjust				o		46
	Replace					o	46
Idle speed	Check-adjust				o (2)		-
Valve clearance	Check-adjust				o (2)		-
Combustion chamber	Clean				o (2)		-
Fuel tank and filter	Check	o					-
	Clean					o (2)	-
Fuel tube	Check	Every 2 years (Replace if necessary) (2)					-
Blade bolt tightness	Check	o					15
Grass bag (applicable type)	Check-clean	o					20
Throttle cable	Check-adjust				o (2)		-
Wheel ratchet	Grease				o (2)		-

(1) Service more frequently when used in dusty areas.

(2) These items should be serviced by your servicing dealer, unless you have the proper tools and are mechanically proficient. Refer to Honda shop manual for service procedures.

(3) Change engine oil every 25 hours when used heavy load or in high ambient temperature.

(4) For commercial use, log hours of operation to determine proper maintenance intervals.

(5) Check that Air cleaner hose does not come off and has no damage (slit, break, hole, etc) for "Air cleaner hose type".

ENGINE MAINTENANCE

Engine Oil Change

Drain the used oil while the engine is warm. Warm oil drains quickly and completely.

1. Turn the fuel valve to the OFF position to reduce the possibility of fuel leakage (see page 10).
2. Wipe the oil filler area clean, then remove the oil filler cap/dipstick.
3. Place a suitable container next to the mower to catch the used oil, then tilt the mower on its right side. The used oil will drain through the filler neck. Allow the oil to drain completely.

Please dispose the used motor oil and the containers in a manner that is compatible with the environment. We suggest you take it in a sealed container to your local recycling center or service station for reclamation. Do not throw it in the trash, pour it on the ground or down a drain.

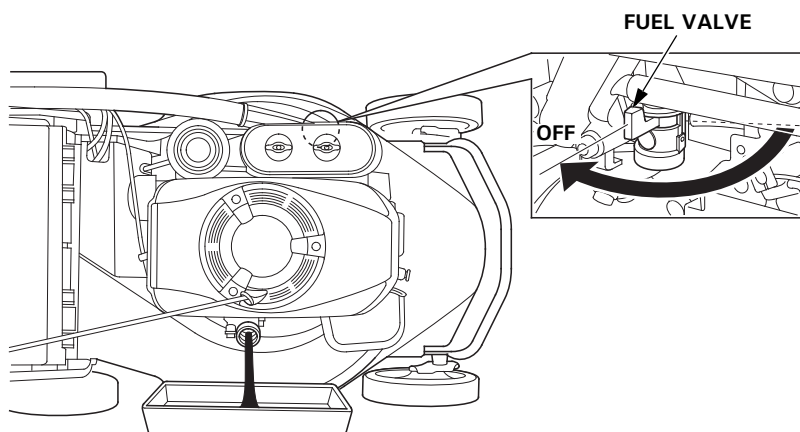

4. Fill with the recommended oil. Do not overfill; measure the oil level as shown on page 44.

Engine oil capacity: 0.65 L

NOTICE

Using nondetergent oil can shorten the engine's service life, and using 2-stroke oil can damage the engine.

5. After changing the engine oil, and before starting the engine, check the oil level with the mower on a level surface:
 - a. Wipe the dipstick clean.
 - b. Insert and remove the dipstick without screwing it into the filler neck. Check the oil level shown on the dipstick.
 - c. If the oil level is low, add oil to reach the upper limit mark on the dipstick. Do not overfill. If the engine is overfilled, the excess oil may get transferred to the air cleaner housing and air cleaner.

NOTICE

Running the engine with a low oil level can cause engine damage.

- d. Screw in the oil filler cap/dipstick securely.

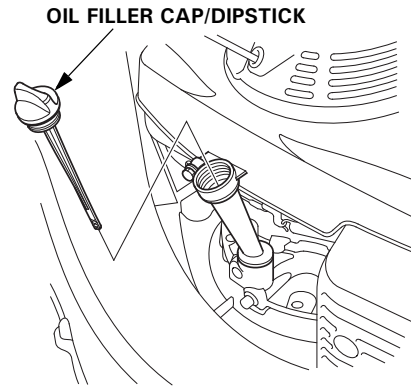

Engine Oil Recommendations

Oil is a major factor affecting performance and service life.

Use 4-stroke motor oil that meets or exceeds the requirements for API service classification SE or later (or equivalent). Always check the API service label on the oil container to be sure it includes the letters SE or later (or equivalent).

SAE 10W-30 is recommended for general use. Other viscosities shown in the chart may be used when the average temperature in your area is within the indicated range.

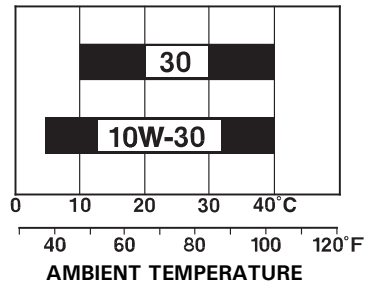
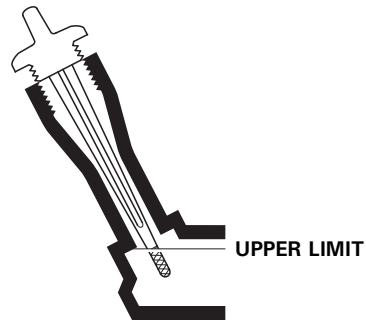

Air Cleaner Service

Dirty air cleaner will restrict air flow to the carburetor, reducing engine performance. If you operate the mower in very dusty areas, clean the air cleaner more often than specified in the MAINTENANCE SCHEDULE.

NOTICE

Operating the engine without an air filters, or damaged filters, will allow dirt to enter the engine, causing rapid engine wear. This type of damage is not covered by the Warranty.

1. Unscrew and remove the two air cleaner nuts, then remove the air cleaner cover.
2. Remove the filter elements from the air cleaner housing, and remove the foam filter element from the paper filter element.
3. Inspect the filter elements for holes or tears; and replace them if damaged.

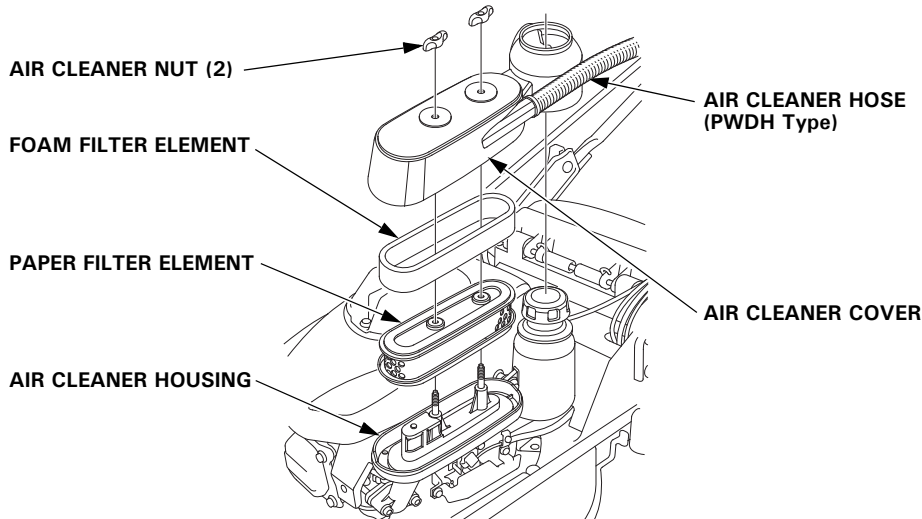

4. Clean the filter elements.

Paper filter element: Tap the filter several times on a hard surface to remove dirt, or blow compressed air (not exceeding 207 kPa) through the filter from the inside. Never try to brush off dirt; brushing will force dirt into the fibers.

Foam element: Clean in warm soapy water, rinse, and allow it to dry thoroughly. Or, clean in nonflammable solvent and allow it to dry. Dip the filter element in clean engine oil, then squeeze out excess oil.

5. Wipe dirt from the inside of the air cleaner housing and cover, using a moist rag. Be careful to prevent dirt from entering the air duct that leads to the carburetor.
6. Reinstall the filters and cover and tighten the air cleaner nuts securely.

Flywheel Brake Lever Operation Inspection

Start the engine outdoors and move the throttle lever to the HIGH position. Release the flywheel brake lever; the engine should stop quickly. If it does not, take your mower to your servicing dealer for repair.

Spark Plug Service

Recommended spark plug: BPR5ES (NGK) or W16EPR-U (DENSO)

NOTICE

An incorrect spark plug can cause engine damage.

For good performance, the spark plug must be properly gapped and free of deposits.

1. Disconnect the spark plug cap and remove dirt from the area.

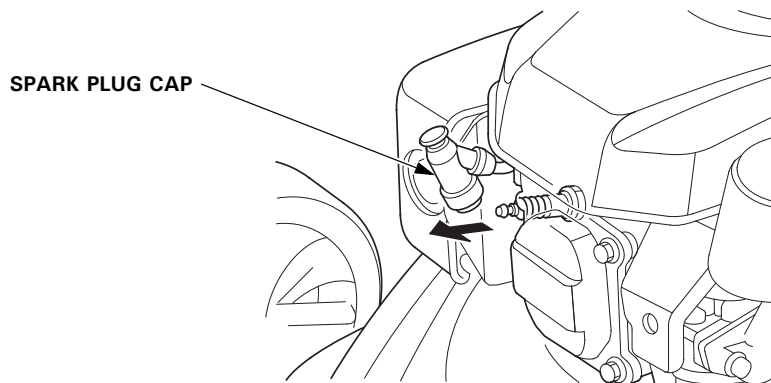

2. Use a spark plug wrench to remove the spark plug.
3. Inspect the plug; replace it if the electrode is worn, or if the insulator is cracked or chipped. Clean plug completely if you are going to reuse it.
4. Measure the spark plug gap with a suitable gauge. The gap should be 0.7–0.8 mm. Correct the gap, if necessary, by bending the side electrode.

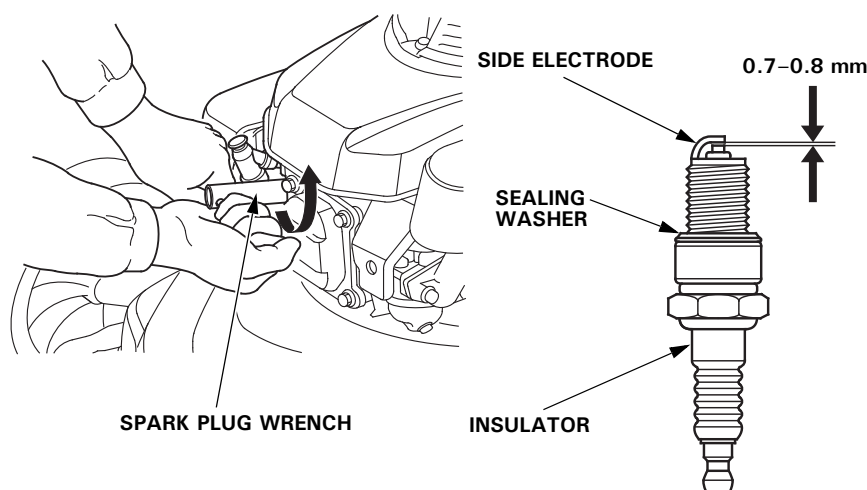

5. Install the spark plug carefully by hand, to avoid cross-threading.
6. After the spark plug seats, tighten with a spark plug wrench to compress the washer.
If reinstalling the old spark plug, tighten 1/8 to 1/4 turn after the spark plug seats.
If installing a new spark plug, tighten 1/2 turn after the spark plug seats.

NOTICE

- A loose spark plug can overheat and damage the engine.
- Overtightening the spark plug can damage the threads in the cylinder head.

7. Install the spark plug cap on the spark plug.

Carburetor Modification for Altitude Operation

At high altitude, the standard air-fuel mixture will be too rich. Performance will decrease, and fuel consumption will increase. A very rich mixture will also foul the spark plug and cause hard starting. High altitude performance can be improved by specific modifications to the carburetor. If you always operate your lawn mower at altitude above 1,500 meters, have your servicing dealer perform this carburetor modifications.

Even with carburetor modification, engine horsepower will decrease about 3.5% for each 300 meters increase in altitude. The effect of altitude on horsepower will be greater than this if no carburetor modification is made.

NOTICE

When the carburetor has been modified for high altitude operation, the air-fuel mixture will be too lean for low altitude use. Operation at altitude below 1,500 meters with a modified carburetor may cause the engine to overheat and result in serious engine damage. For use at low altitude, have your servicing dealer return the carburetor to original factory specifications.

Fuel Recommendations

Use unleaded gasoline with a Research Octane Number of 91 or higher. This engine is certified to operate on unleaded gasoline. Unleaded gasoline produces fewer engine and spark plug deposits and extends exhaust system life. Never use stale or contaminated gasoline or an oil/gasoline mixture. Avoid getting dirt or water in the fuel tank. Occasionally you may hear light "spark knock" or "pinging" (metallic rapping noise) while operating under heavy loads. This is no cause for concern. If spark knock or pinging occurs at a steady engine speed, under normal load, change brands of gasoline. If spark knock or pinging persists, see your servicing dealer.

NOTICE

Running the engine with persistent spark knock or pinging can cause engine damage. Running the engine with persistent spark knock or pinging is misuse, and the Warranty does not cover parts damaged by misuse. For oxygenated fuel information, refer to page 36.

BLADE REMOVAL AND INSTALLATION

If you remove the blade, use a torque wrench to reinstall. Wear heavy gloves to protect your hands. To avoid weakening the blade, or causing imbalance or poor cutting, the blade should be sharpened by trained staff at your servicing dealer. If replacing the blade, use a Honda genuine replacement blade or equivalent.

Removal

1. Turn the fuel valve to the OFF position.
2. Disconnect the spark plug cap, then tilt the mower to the right side, so the carburetor side is up.
3. Hold the blade disc firmly, and remove the blade disc holder bolt.

Set a flat blade screwdriver at the engine's bolt to prevent the blade disc from turning when removing the blade disc holder bolt.

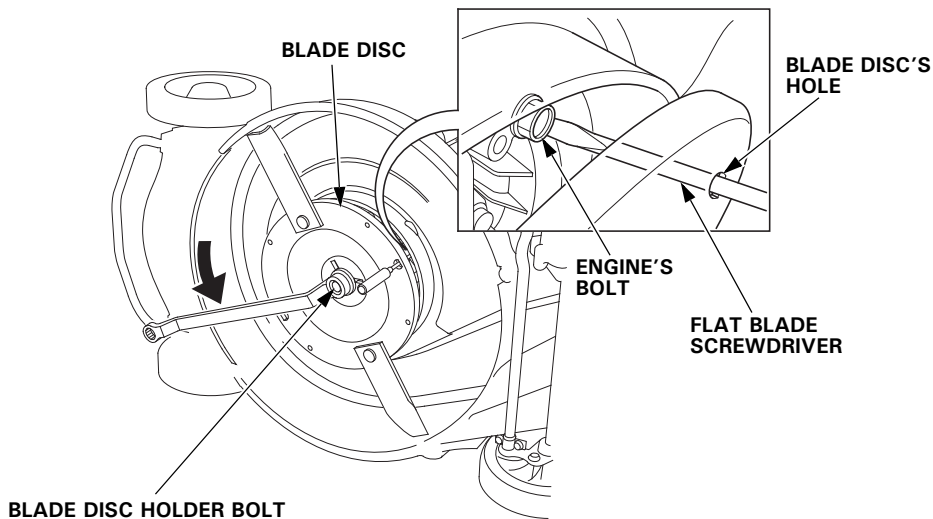
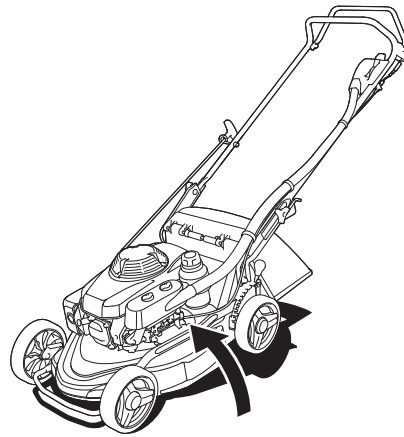
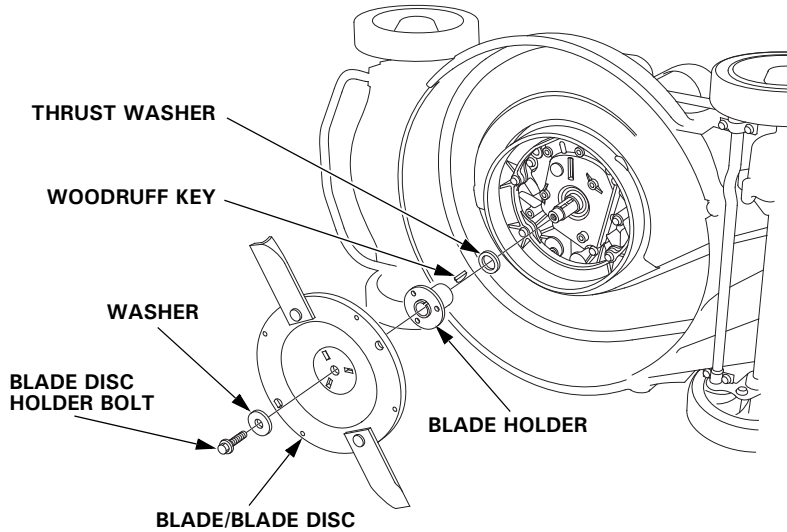
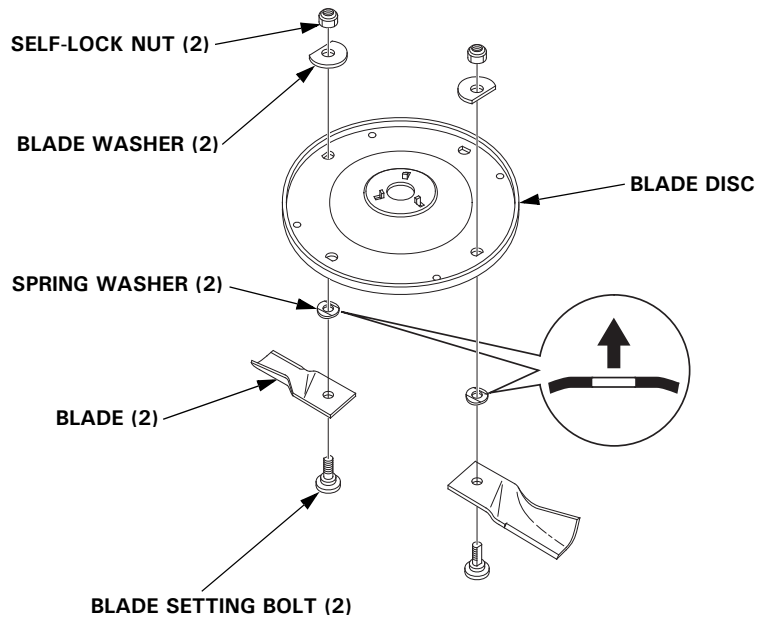

Illustration showing the blade disc holder bolt, washer, blade/blade disc, blade holder, woodruff key, and thrust washer removed.



4. Remove the blade setting bolt, blade, spring washer, blade washer and self-lock nut from the blade disc.



Installation

1. Clean dirt and grass from the blades, blade disc, and the inside on the cutter housing.
2. Install the blade, spring washer, blade washer and self-lock nut to the blade disc using the blade setting bolt as described below.

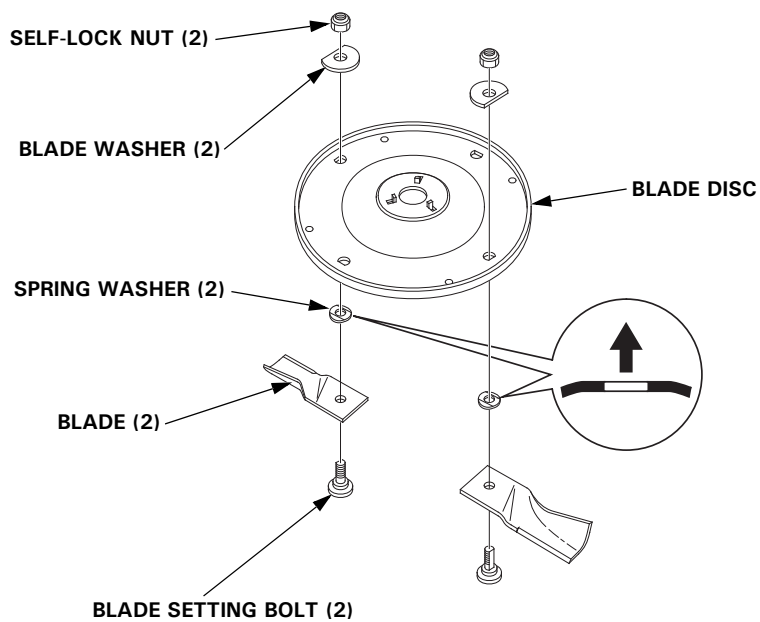

3. Tighten the self-lock nuts with a torque wrench. Prevent the blade disc from turning when tightening the self-lock nuts, tighten the self-lock nuts to the specified torque.

The blade setting bolts are specially designed for the mower. Should you ever have to replace them, use only Honda genuine parts. Otherwise, the blade may detach from the mower and cause serious injury.

Self-lock nuts tightening torque:
34.3 N·m (3.5 kgf·m)

4. Install the thrust washer, woodruff key, blade holder, blade/blade disc, washer and blade disc holder bolt.

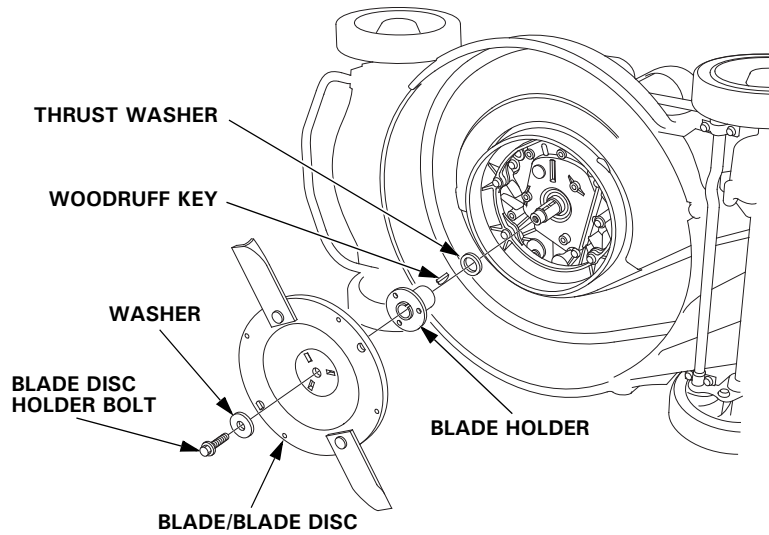

5. Hold the blade disc firmly, and install the blade disc holder bolt.

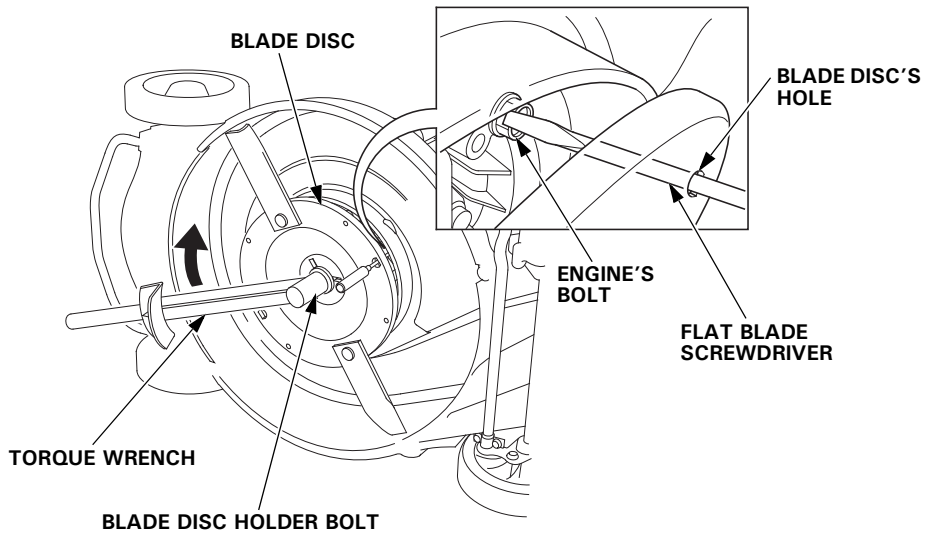

Tighten the blade disc holder bolt with a torque wrench. Set a flat blade screwdriver at the engine's bolt to prevent the blade disc from turning when tightening the blade disc holder bolt, tighten the blade disc holder bolt to the specified torque.

**Blade disc holder bolt tightening torque:
53.9 N·m (5.5 kgf·m)**

6. After installing the blade/blade disc check that it does not interfere with the cutter housing. If the blade contacts the cutter housing, consult your servicing dealer.

▲WARNING

A bent blade can be the cause of serious personal injury or accident.

If you don't have a torque wrench, have your servicing dealer tighten the blade setting bolts and the blade disc holder bolt before you use the mower. If the blade setting bolts and the blade disc holder bolt are overtightened, they could break. If the blade setting bolts and the blade disc holder bolt are not tightened enough, they could loosen or come out. In either case, it would be possible for the blade to fly off while you are operating the mower.

GRASS BAG CLEANING AND REPLACEMENT

Grass Bag Cleaning

Wash the bag with a garden hose, and allow it to dry completely before use; a wet bag will clog quickly.

Grass Bag Replacement

Replace a worn or damaged bag with a Honda genuine bag or its equivalent.

Grass Bag Removal

Unclip the plastic edges of the bag from the frame. Remove the bag from the frame.

Grass Bag Installation

Insert the frame into the new bag. Clip the plastic edges to the frame as shown.

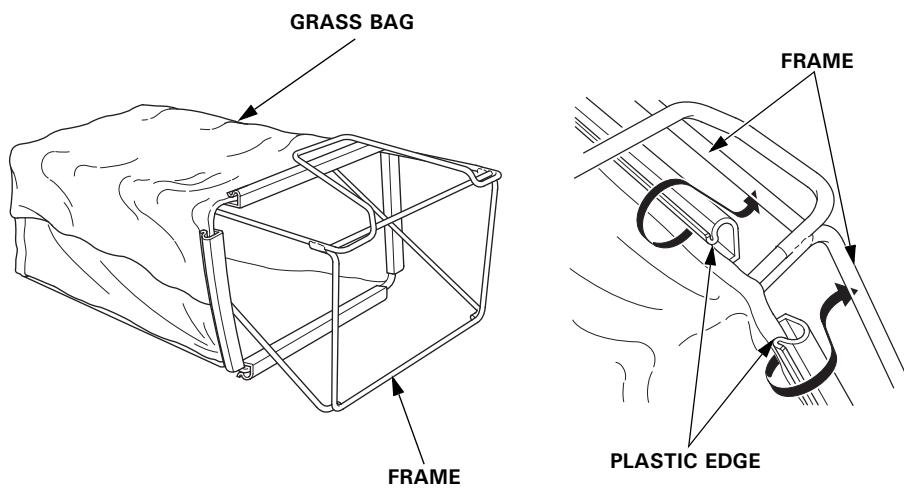

8. TROUBLESHOOTING

ENGINE PROBLEMS

Engine Will Not Start	Possible Cause	Correction
1. Check control positions.	Fuel valve OFF.	Turn fuel valve ON (p. 23).
	Throttle lever in wrong position.	Move throttle lever to CHOKE position, unless the engine is warm (p. 24).
2. Check fuel.	Out of fuel.	Refuel (p. 19).
	Bad fuel; mower stored without treating or draining gasoline, or refueled with bad gasoline.	Drain fuel tank and carburetor (p. 37). Refuel with fresh gasoline (p. 19).
3. Remove and inspect spark plug.	Spark plug faulty, fouled, or improperly gapped. Spark plug wet with fuel (flooded engine).	Clean, adjust or replace spark plug (p. 46). Dry and reinstall spark plug. Start engine with throttle lever in HIGH position.
4. Take mower to your servicing dealer, or refer to shop manual.	Fuel filter clogged, carburetor malfunction, ignition malfunction, valves stuck, etc.	Replace or repair faulty components as necessary.

Loss of Power	Possible Cause	Correction
1. Check throttle position.	Throttle not set to HIGH.	Move throttle to HIGH (p. 24).
2. Check grass height.	Grass too tall to cut.	Raise cutting height (p. 22), cut narrower swath (p. 31), or cut more frequently.
3. Check under cutter housing.	Cutter housing clogged.	Clean out cutter housing (p. 35).
4. Check air filter.	Air filter clogged.	Clean or replace air filter (p. 45).
5. Check fuel.	Bad fuel; mower stored without treating or draining gasoline, or refueled with bad gasoline.	Drain fuel tank and carburetor (p. 37). Refuel with fresh gasoline (p. 19).
6. Take mower to your servicing dealer, or refer to shop manual.	Fuel filter clogged, carburetor malfunction, ignition malfunction, valves stuck, etc.	Replace or repair faulty components as necessary.

VIBRATION PROBLEMS

Excessive Vibration	Possible Cause	Correction
1. Check cutter housing and blade.	Grass and debris lodged under cutter housing.	Clean out cutter housing (p. 35).
	Blade loose, bent, damaged, or unbalanced by improper sharpening.	Tighten loose blade bolts. Replace damaged blade (p. 49).
2. Take mower to your servicing dealer for repair.	Mechanical damage, such as a bent crankshaft.	Replace or repair faulty components as necessary.

MOWING AND BAGGING PROBLEMS

Poor Cut Quality or Poor Mowing/Bagging Performance	Possible Cause	Correction
1. Check that the throttle lever is in the HIGH position.	Engine speed is too slow to cut well.	Move throttle lever to the HIGH position (p. 24).
2. Check cutting height adjustment lever.	Adjustment lever set at incorrect position.	Set lever at the correct height position (p. 22, 31).
3. Check grass bag (if equipped).	Grass bag overfilled or clogged.	Empty the grass bag. Wash the grass bag if clogged with dirt (p. 54).
4. Check cutter housing and blade.	Cutter housing clogged.	Clean out the cutter housing (p. 35).
	Blade dull, worn, or damaged.	Sharpen or replace blade if necessary (p. 49).
	Wrong blade installed.	Install correct blade (p. 51).

9. SPECIFICATIONS

MOWER MODELS

Model	HRJ196
Description Code	MADC
Type	Manually propelled

DIMENSIONS, WEIGHTS AND CAPACITIES

Model	HRJ196	
Type	PDDH	PWDH
Overall Length	1,560 mm	
Overall Width	505 mm	
Overall Height	1,025 mm (with cutting height set at 27 mm)	
Dry Mass (weight)	40 kg	41 kg
Wheel Base	565 mm	
Tread	Front	440 mm
	Rear	458 mm
Cutting Width	470 mm	
Grass Bag Capacity	60 L	
Cutting Height (11 steps adjustable)	16–75 mm	
Fuel Tank Capacity	1.5 L	

ENGINE DESIGN AND PERFORMANCE

Model	HRJ196
Engine Model	GXV160
Engine Type	4-stroke, overhead valve, forced air-cooled
Displacement	163 cm ³
Bore and Stroke	Ø68.0 × 45.0 mm
Compression Ratio	8.0:1
Engine Net Power (in accordance with SAE J1349*)	3.2 kW (4.3 HP) at 3,600 rpm (PDDH type) 2.7 kW (3.6 HP) at 3,000 rpm (PWDH type)
Engine Max. Net Torque (in accordance with SAE J1349*)	9.6 N·m (0.98 kgf·m) at 2,500 rpm (PDDH type) 9.0 N·m (0.92 kgf·m) at 2,500 rpm (PWDH type)
Ignition System	Transistor type magneto ignition
Fuel	Unleaded gasoline with a Research Octane Number of 91 or higher
Engine Oil	SAE 10W-30, API SE or later
Engine Oil Capacity	0.65 L
Spark Plug Type	BPR5ES (NGK), W16EPR-U (DENSO)
Spark Plug Gap	0.7–0.8 mm
Engine Set Speed (with blades)	3,200 ⁰ ₋₁₅₀ rpm
Idle Speed	1,700 ± 150 rpm
Valve Clearance (cold)	Intake: 0.15 ± 0.02 mm Exhaust: 0.20 ± 0.02 mm

*: The power rating of the engine indicated in this document is the net power output tested on a production engine for the engine model and measured in accordance with SAE J1349 at 3,600 rpm (PDDH type) or 3,000 rpm (PWDH type) (Engine Net Power) and at 2,500 rpm (Engine Max. Net Torque). Mass production engines may vary from this value.

Actual power output for the engine installed in the final machine will vary depending on numerous factors, including the operating speed of the engine in application, environmental conditions, maintenance, and other variables.

10. SET-UP INSTRUCTION

Unpacking

Remove all protective cardboards from the mower, including the piece around the handlebar.

Grass Bag Installation

Refer to page 54 for grass bag installation.

Handlebar Setup

1. Remove the handlebar locking knobs from the handlebar mounting section of the cutter housing.
2. Set the lower section of the handlebar to the handlebar mounting section of the cutter housing enough so you can raise the handlebar into the normal position.
3. Loosely install the washers and handlebar locking knobs.
4. Raise the handlebar in place.
5. Tighten the handlebar locking knobs securely.
6. Install the rope guide to the handlebar, and then tighten the flange bolt and lock nut securely.
7. Remove the wire bands from the cables.
8. Install the air cleaner hose to the air cleaner cover and throttle lever cover (PWDH Type).

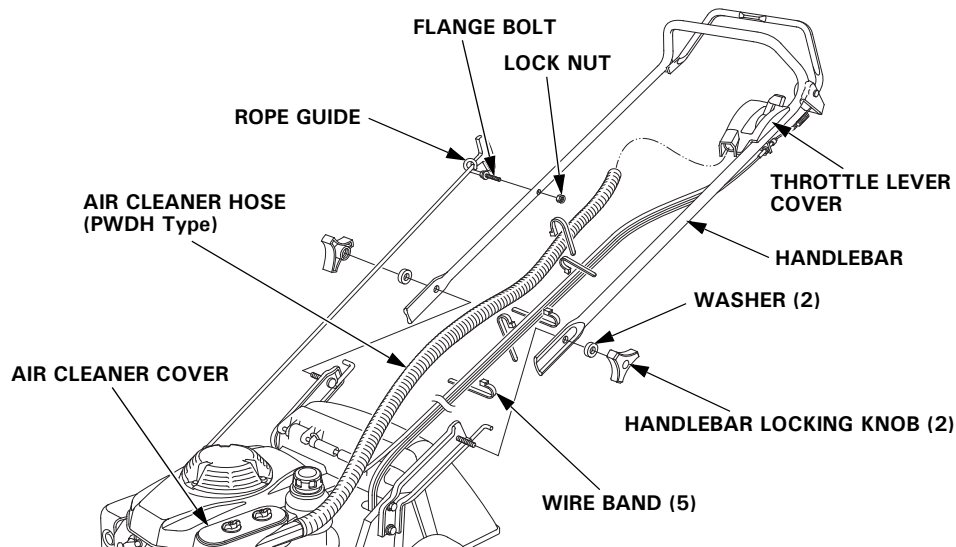

9. Secure the wires and air cleaner hose with the wire band as shown below (PWDH Type).

Secure the wires with the wire band as shown below (PDDH Type).

PWDH Type

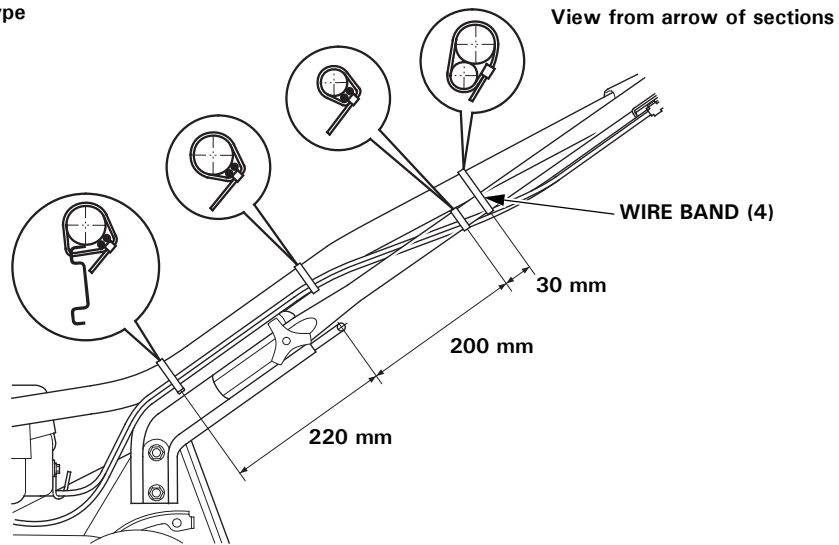

PDDH Type

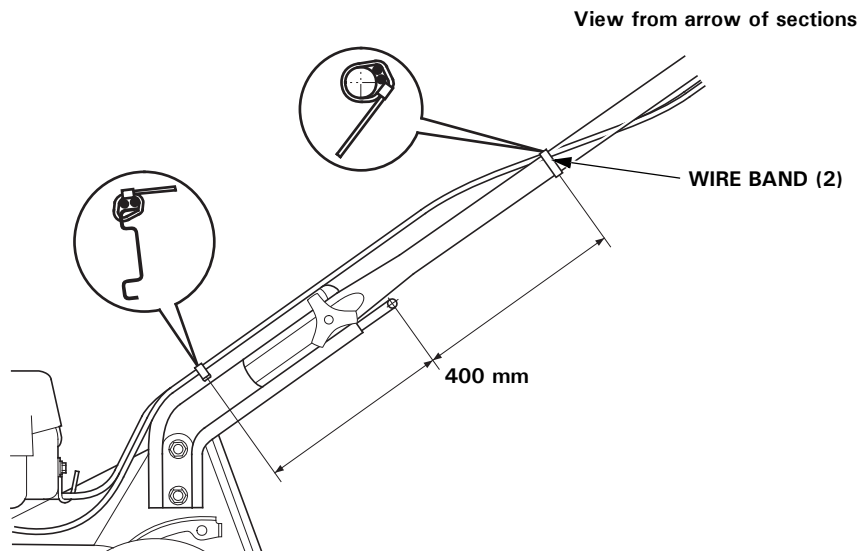

11. INDEX

A	
Air Cleaner	20
Air Cleaner Hose (PWDH Type)	20
Air Cleaner Service	45
ARE YOU READY TO MOW?	14
B	
BEFORE LOADING	34
Blade	15
BLADE REMOVAL AND INSTALLATION	49
C	
Carburetor Modification for Altitude Operation	48
CHECK YOUR LAWN	14
CHECK YOUR MOWER	15
COMPONENT IDENTIFICATION	8
CONTROLS	10
Cutting Height	22
Cutting Height Adjustment Lever	12
D	
DESCRIPTION OF CONTROLS	10
E	
Emergency Engine Stop	27
ENGINE MAINTENANCE	43
Engine Oil Change	43
Engine Oil Level	18
Engine Oil Recommendations	44
F	
Flywheel Brake Lever	11, 26
Flywheel Brake Lever Operation Inspection	46
Front Guard	13
Fuel	19
Fuel Recommendations	48
Fuel Valve	10
G	
Grass Bag	20
GRASS BAG CLEANING AND REPLACEMENT	54

H	
Handlebar Folding	38
I	
INDEX	61
L	
LOADING AND UNLOADING	34
M	
MAINTENANCE SAFETY	41
MAINTENANCE SCHEDULE	42
MAINTENANCE	40
MOWING PRECAUTIONS	23
MOWING TIPS	31
N	
Normal Engine Stop	27
O	
OPERATING THE CONTROLS FOR MOWING	26
OPERATION	23
P	
PRE-OPERATION CHECKS	14
R	
REMOVAL FROM STORAGE	39
S	
SAFE MOWING PRACTICES	29
SAFETY INSTRUCTIONS	4
SAFETY LABEL LOCATIONS	7
SET-UP INSTRUCTION	59
Spark Plug Service	46
SPECIFICATIONS	57
STARTING THE ENGINE	23
STOPPING THE ENGINE	27
STORAGE PRECAUTIONS	39
STORAGE PREPARATION	35
T	
THE IMPORTANCE OF MAINTENANCE	40
Throttle Lever	10, 26
TRANSPORTING/STORAGE	34
TROUBLESHOOTING	55

